

# MathFest

Lexington, Kentucky | August 4–6

2011



**MAA**

MATHEMATICAL ASSOCIATION OF AMERICA



Find the derivative of  $y = 2 \cos(3x - \pi)$  with respect to  $x$ .

$$\frac{dy}{dx} = \boxed{6 \cdot \sin 3x}$$

“SORRY, THAT’S NOT CORRECT.”

“THAT’S CORRECT.”

## **TWO ONLINE HOMEWORK SYSTEMS WENT HEAD TO HEAD. ONLY ONE MADE THE GRADE.**

What good is an online homework system if it can't recognize right from wrong? Our sentiments exactly. Which is why we decided to compare WebAssign with the other leading homework system for math. The results were surprising. The other system failed to recognize correct answers to free response questions time and time again. That means students who were actually answering correctly were receiving failing grades. WebAssign, on the other hand, was designed to recognize and accept more iterations of a correct answer. In other words, WebAssign grades a lot more like a living, breathing professor and a lot less like, well, that other system.

So, for those of you who thought that other system was the right answer for math, we respectfully say, “Sorry, that’s not correct.”

**WebAssign**<sup>®</sup>

*The way you imagined teaching could be.<sup>™</sup>*



# MathFest

Lexington, Kentucky | August 4–6 2011

## Table of Contents

3	Invited Addresses
7	Invited Paper Sessions
8	Contributed Paper Sessions
9	Panels and Other Sessions
10	Undergraduate Student Sessions
11	Graduate Student Activities
12	Alder Awards
13	SIGMAA Activities
14	Minicourses
15	Short Course
16	Workshops and Other Sessions
17	Exhibitors
22	Map of Lexington
VIII	Floor Plans
24	Timetable
42	Social Events
43	Pentominoku

# MAA MathFest 2011

**Join Maplesoft™ at MAA MathFest 2011 and revolutionize your testing, assessment and placement testing!**

## **A New Generation of Placement Testing**

**Presented by Louise Krmpotic, Director, Business Development, Maplesoft**

**Friday, August 5 • 1:00pm to 2:30pm**  
**Woodford Suite, Hyatt Hotel**

The Maple T.A. MAA Placement Test Suite (PTS) combines tests based on current research in education with a powerful, online testing engine to provide the next generation of placement testing. PTS provides a completely flexible platform giving you control over not only what tests you use, but how and when your tests are run. Come to this session to see the difference PTS can make in your placement testing program.

*Louise Krmpotic earned her Bachelor of Mathematics and Masters of Mathematics from the University of Waterloo in Canada. She also holds a Bachelor of Education from Althouse College, the Faculty of Education at the University of Western Ontario in London, Ontario. At Maplesoft, Mrs. Krmpotic has been responsible for several key initiatives, from product development to training and content development. She currently oversees key relationships with higher-educational publishers and is responsible for finding and developing new business opportunities.*

**Visit the Maplesoft booth #21 and get a custom demonstration of the latest products from Maplesoft!**

**Maple 15**

The Essential Tool for Mathematics and Modeling

Maple is an essential tool for researchers, teachers, and students in any mathematical or technical discipline. It lets you explore, visualize, and solve even the most complex mathematical problems, reducing errors and providing greater insight into the math

**Maple T.A. 7**

Online Testing and Assessment ... Powered by Maple™

Maple T.A. provides everything you would expect in an assessment system plus features designed specifically for technical courses involving mathematics.

**Maple T.A.™ MAA  
Placement Test Suite 7**

Partnering with the MAA to revolutionize placement testing

Allows your institution to use the renowned Mathematical Association of America (MAA) placement tests through an online testing environment. Built on Maple T.A., users have the option of only using the placement tests, or taking advantage of the full power of Maple T.A.



# Invited Addresses

## Earle Raymond Hedrick Lecture Series

Manjul Bhargava, *Princeton University*



### The World of Algebraic Curves (and the Special Role That Elliptic Curves Play)

#### Lecture 1

Thursday, August 4, 10:30 a.m. to 11:20 a.m.

### From Right-Angled Triangles to Algebraic Curves

The classical and ancient problem of finding right-angled triangles with integer side lengths has a natural and beautiful solution in terms of the geometry of conics. In this lecture, we describe this method and how it can be adapted to find all rational points—i.e., points having rational coordinates—on any conic (ellipse, parabola, or hyperbola) in the plane.

The method immediately leads to questions about curves in the plane of higher degree and, in particular, to elliptic curves.

#### Lecture 2

Friday, August 5, 9:30 a.m. to 10:20 a.m.

### The Special Role of Elliptic Curves

Unlike conics, which are curves in the plane defined by equations of degree two, elliptic curves are defined by equations of degree three. This slight change already makes elliptic curves very different from conics, and it also turns out that the behavior of elliptic curves is drastically different than that of curves of degree four and higher.

What really sets elliptic curves apart is that the set of rational points on an elliptic curve has a natural group structure. In this lecture, we describe this group structure and explain how it can be used to answer many questions about elliptic curves (and other objects) that would be difficult to answer otherwise. We also describe many open questions, as well as some recent progress on their answers.

#### Lecture 3

Saturday, August 6, 9:30 a.m. to 10:20 a.m.

### How Many Points Are Needed, on Average, to Generate All Rational Points on an Elliptic Curve?

A rational elliptic curve may be viewed as the set of solutions to an equation of the form  $y^2 = x^3 + Ax + B$ , where  $A$  and  $B$  are rational numbers. The set of rational points on this curve possesses a natural abelian group structure, and the Mordell-Weil theorem states that this group is always finitely generated. The rank of a rational elliptic curve measures *how many* rational points are needed to generate all the rational points on the curve.

There is a standard conjecture—originating in work of Goldfeld and Katz-Sarnak—that states that the average rank of all elliptic curves should be  $1/2$ ; however, it has not previously been known that the average rank is even finite! In this lecture, we describe recent work that shows that the average rank is finite; in fact, we show that the average rank is less than 1! It follows that many—indeed, we show at least 10 percent of—elliptic curves have no rational points.

This is joint work with Arul Shankar.

## AMS-MAA Joint Invited Address

Thursday, August 4, 8:30 a.m. to 9:20 a.m.

Laura DeMarco, *University of Illinois, Chicago*

### Polynomial Dynamics: Conjugacy and Combinatorics



In the study of any collection of dynamical systems, one of the main goals is a classification of possibilities. Ideally, for each equivalence class of systems, we can find a simple model that captures all of the important long-term information about the system.

In this talk, I will introduce this problem of classification in the setting of complex one-dimensional polynomials. I will describe some of the combinatorial tools that have been used to address this problem, with the aim of presenting recent work (joint with Kevin Pilgrim) about the conjugacy classes and the geometry of the moduli space of polynomials.

# Invited Addresses (continued)

## MAA Invited Address

Thursday, August 4, 9:30 a.m. – 10:20 a.m.

**Edward Burger**, *Williams College*

### Planting Your Roots in the Natural Numbers: A Rational and Irrational Look at 1, 2, 3, 4, ...



Some people see magical features in the famous Fibonacci numbers and the alluring golden ratio  $\phi$ . But what if you replace the famous  $\phi$  with your favorite obscure quadratic irrational real number? Is the magic still there? Here in 1 hour, 2 examples, 3 theorems, and 4 acts we'll consider these questions,

highlight their history, and share some recent insights that will transfigure the magic into mathematics. Revealing any more here would be simply *ab-surd*.

## MAA Invited Address

Saturday, August 6, 8:30 a.m. – 9:20 a.m.

**Lauren Ancel Meyers**, *University of Texas, Austin*

### Mathematical Approaches to Infectious Disease Prediction and Control



Mathematics has long been an important tool for understanding and controlling the spread of infectious diseases. I will present an overview of compartmental models, the traditional approach to modeling infectious disease dynamics, and then introduce contact network epidemiology, a relatively new

approach that applies bond percolation on random graphs to model the spread of infectious disease through heterogeneous populations.

As I will illustrate, these methods can be used to address public health challenges and have recently been coupled with powerful computational methods to optimize epidemic control strategies.

## MAA Invited Address

Saturday, August 6, 10:30 a.m. – 11:20 a.m.

**Annalisa Crannell**, *Franklin & Marshall College*

### In the Shadow of Desargues



One of us who teach projective geometry often nod to perspective art as the spark from which projective geometry caught fire and grew. This talk looks directly at projective geometry as a tool to illuminate the workings of perspective artists. We will particularly shine the light on

Desargues's triangle theorem (which says that any pair of triangles that is perspective from a point is perspective from a line), together with an even simpler theorem (you have to see it to believe it!). Given any convoluted, complicated polygonal object, these theorems allow us to draw that object together with something that is related to it—its shadow, reflection, or other rigid symmetries—and we'll show how this works. If you enjoy doodling or sketching, bring your pencil, a good eraser, and a straightedge.

## AWM-MAA Etta Z. Falconer Lecture

Friday, August 5, 8:30 a.m. – 9:20 a.m.

**Dawn Lott**, *Delaware State University*

### Mathematical Interventions for Aneurysm Treatment



Aneurysm is a vascular disease characterized by a weak or thin spot on a blood vessel that balloons out and fills with blood. Cerebral aneurysm can occur anywhere in the brain, but most are located along a loop of arteries that run between the underside of the brain and the base of the skull (Circle of Willis). Cerebral aneurysms are particularly dangerous because of their difficulty to treat and their high mortality and morbidity rate. There are several risk factors for cerebral aneurysm, among which are hypertension, heavy alcohol consumption, and cigarette smoking. Rupture of cerebral aneurysm (subarachnoid hemorrhage) can cause stroke. Understanding the mathematical relationships

between the mathematical relationships

## Invited Addresses (continued)

and the hemodynamic factors predisposing aneurysms to further growth and rupture will enable neurosurgeons to determine which aneurysms have a high likelihood of rupture and thus should be treated. In addition, such knowledge may also help predict which aneurysms will never rupture.

In making such predictions, only patients with a risk of aneurysmal rupture would be exposed to the risk of surgery. This talk will discuss mathematical and biomechanical interventions for aneurysm treatment and will address societal effects of this vascular disease.

### James R. Leitzel Lecture

Friday, August 5, 10:30 a.m. – 11:20 a.m.

**Philip Kutzko**, *University of Iowa*

#### Just Walk Away, RenŽ: Cultural Issues in Broadening Participation in Mathematics



Science, as we know it today, developed in a particular time and place for reasons that have never fully been explained. The concept of a function—a concept that underlies all of modern science—first appears in Descartes’s *La Géométrie* in 1637; within a generation, Newton and Leibniz had developed the calculus

and Newton had laid the foundation for modern physics. Similar transformative advances occurred shortly thereafter in chemistry, biology, and medicine. This is the context in which we do science today; a West European, Cartesian context in an increasingly non-European nation.

The Western approach to science embodies certain cultural values, among them skepticism, objectivity, secularism, and a belief in progress as an unmixed virtue. These values are by no means universally accepted, either internationally or within our own country. Further, they have sometimes been used to justify aggression and sometimes worse by Europeans and their descendants in the Americas against other ethnic groups and even against groups within European society. This, it would seem, is reason enough for underrepresented minority groups and other Americans who have not historically been invited to the table to steer clear of European science.

Any approach toward broadening participation in science that fails to take into account this cultural context can go only so far. Examples are afforded by standardized testing and affirmative action, each of which is ultimately motivated by the same goal: to remove impediments to access caused by overt ethnic and class discrimination (standardized tests) and by the consequences of such discrimination (affirmative action).

Both have been valuable in extending access to ethnic and national groups who have found Western science culturally appealing as well as to individuals with similar proclivities from underrepresented groups; indeed, the use of standardized testing transformed the populations doing science during the *Sputnik* era while affirmative action has been responsible for similar transformations in more recent times. However, these and other strategies that have focused largely on removing barriers to inclusion may be nearing the limit of their utility.

One of the distinctive features of Iowa’s math department’s initiative to broaden participation in our graduate program is the awareness we have developed of the cultural context in which our effort takes place. I will discuss this cultural context in my talk and argue that an understanding of this context can lead to new strategies, strategies that, in our case, have transformed a traditional mathematics department in an ethnically homogeneous state into what some have called a model for what an American math department should look like in the 21st century.

### Pi Mu Epsilon J. Sutherland Frame Lecture

Friday, August 5, 8:00 p.m. – 8:50 p.m.

**Margaret Wright**, *Courant Institute of Mathematical Sciences*

#### You Can’t Top This: Making Things Better with Mathematics



Many problems in science, engineering, medicine, and life involve choosing the best way (or at least a better way) to do something. Mathematical optimization can often provide the answers we want; the speaker will describe when, why, and how this happens, along with a few examples.

# Invited Addresses (continued)

## NAM David Blackwell Lecture

Friday, August 5, 1:00 p.m. to 1:50 p.m.

**Farrah Jackson Chandler**, *Elizabeth City State University*

### Using e-Mentoring to Prepare the Next Generation of Mathematics Teachers



It has been well documented that the mathematics and science scores of U.S. students are lagging behind those of their international peers. A study conducted by the National Commission on Mathematics and Science Teaching for the 21st century suggests that providing more training and professional

development opportunities for teachers is the clearest way to increase the achievement level of students in both mathematics and science. In this talk, I will present an overview of work that I have been involved in to prepare and train mathematics teachers through e-mentoring.

## MAA Lecture for Students

Thursday, August 4, 1:00 p.m. to 1:50 p.m.

**Roger Nelsen**, *Lewis & Clark College*

### Math Icons



An icon (from the Greek for “image”) is defined as a picture that is universally recognized to be representative of something. The world is full of distinctive icons. Flags and shields represent countries, graphic designs represent commercial enterprises, and computer icons are essential tools for working with a variety of electronic devices from desktop computers to cell phones.

What are the icons of mathematics? Numerals? Symbols? Equations? After many years of working with visual proofs, I believe that certain geometric diagrams play a crucial role in visualizing mathematical proofs. In this talk I’ll present several of these diagrams, which I call *math icons*, and explore the mathematics that lies within, and that can be created with them.

# An invitation to explore ... <http://mathcircles.org>

## National Association of Math Circles (NAMC)

*Providing resources to create new Math Circles, maintaining a directory of programs, and supporting the development of the Math Circle community.*

### What is a Math Circle?

Mathematicians and mathematical scientists meet with pre-college students (and sometimes their teachers) in informal settings to work on interesting problems and topics in mathematics. These interactions excite students about mathematics and provide them with a community to foster their passion for mathematical thinking.

### The Math Circles Experience

Math Circles emphasize bringing together professional mathematicians and secondary school students on a regular basis for problem solving and mathematical exploration.

The NAMC Website (<http://mathcircles.org>) includes Circle in a Box wiki, Lesson Plans and videos of sample circle sessions, contact information for existing Math Circles, the Math Circle Problem Collection, and a forum for NAMC members to discuss Math Circles. The NAMC site links to the *Circle in a Box* book and *Within the Circle* DVD.

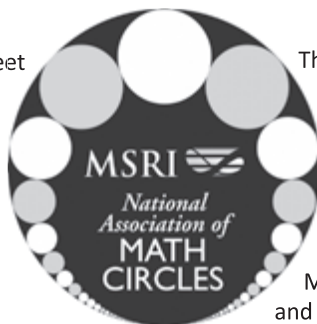

### The annual NAMC CIRCLE ON THE ROAD

**WORKSHOP** combines a Math Festival with many sample circle sessions. The workshop serves as an introduction to instructional techniques for circle leaders and a laboratory for circle evaluators.

This workshop gives those wishing to start Math Circles a hands-on introduction to activities and the benefit of the advice of experienced circle leaders. If you are unable to attend

Circle on the Road you can participate with online videos and other program resources on the NAMC website.



**Math Circle Mini Grants are available for those interested in starting a program. For more information stop by the NAMC Booth!**

Mathematical Sciences Research Institute • [www.msri.org](http://www.msri.org) • Shiing-Shen Chern Hall • 17 Gauss Way, Berkeley, CA 94720-5070



# Invited Paper Sessions

For full descriptions of the Invited Paper Sessions, go to <http://www.maa.org/mathfest/ips.html>.

## Connections to Complex Dynamics

Part 1. Thursday, August 4, 1:00 p.m. – 4:30 p.m.  
Part 2. Friday, August 5, 1:00 p.m. – 4:30 p.m.

Rodrigo Perez, Indiana University–Purdue University, Indianapolis; Roland Roeder, Indiana University–Purdue University, Indianapolis

**Speakers:** Arceli Bonifant, Joshua Bowman, Clinton Curry, Jeffrey Diller, Jan-Li Lin, Phil Mummert, Rodrigo Perez, Roland Roeder, Paul Blanchard, and Bob Devaney.

## Offering Students Lessons Beyond Mathematics, through Mathematics

Part 1. Thursday, August 4, 2:00 p.m. – 4:00 p.m.  
Part 2. Friday, August 5, 2:30 p.m. – 4:00 p.m.

Edward Burger, Williams College

**Speakers:** Deborah J. Bergstrand, Christina Carter, Candice Dance, Harry Lucas Jr., Lew Ludwig, Colm Mulcahy, Michael Starbird

## Polyhedra Are Everywhere!

Friday, August 5, 2:00 p.m. – 5:00 p.m.

Benjamin Braun, University of Kentucky

**Speakers:** Matthias Beck, Jeffrey Blanchard, Jesus De Loera, Caroline Klivans, Carl Lee, Margaret Readdy

## Projective Geometry Applied to Perspective Art

Saturday, August 6, 1:00 p.m. – 4:00 p.m.

Annalisa Crannell, Franklin & Marshall College;  
Marc Frantz, Indiana University

**Speakers:** Marc Frantz, Tomás García-Salgado, Don Row, Talmadge James Reid, Dick Termes, Norman Wildberger

## Cultural and Philosophic Underpinnings of Western Science: Implications for American Mathematics in the 21st Century

Philip Kutzko, University of Iowa

**Speakers:** Paulette Willis, David Manderscheid, Douglas Mupasiri, Edray Goins

## New Mathematics and Statistics Titles from Authors You Trust

David C. Lay

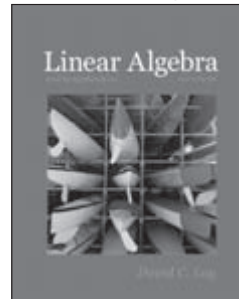

*Linear Algebra and Its Applications, Fourth Edition*  
© 2012  
ISBN-13: 978-0-321-38517-8  
ISBN-10: 0-321-38517-9

Nagle • Saff • Snider

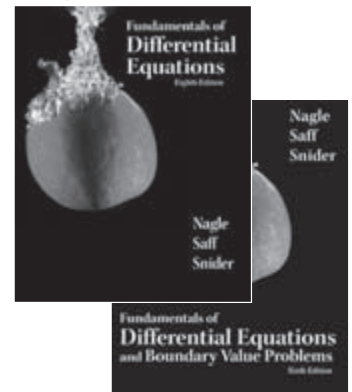

*Fundamentals of Differential Equations, Eighth Edition*  
© 2012  
ISBN-13: 978-0-321-74773-0  
ISBN-10: 0-321-74773-9

*Fundamentals of Differential Equations and Boundary Value Problems, Sixth Edition*  
© 2012  
ISBN-13: 978-0-321-74774-7  
ISBN-10: 0-321-74774-7

Samuels • Witmer • Schaffner

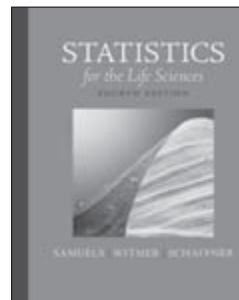

*Statistics for the Life Sciences, Fourth Edition*  
© 2012  
ISBN-13: 978-0-321-65280-5  
ISBN-10: 0-321-65280-0

Walpole • Myers • Myers • Ye



*Probability and Statistics for Engineers and Scientists, Ninth Edition*  
© 2012  
ISBN-13: 978-0-321-62911-1  
ISBN-10: 0-321-62911-6

## New First Edition

Mark Watkins and Jeffrey Meyer of Syracuse University have spent many years successfully preparing students for courses in advanced mathematics. This text is an outgrowth of their work.

Watkins • Meyer

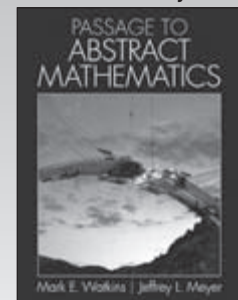

*Passage to Abstract Mathematics*  
© 2012  
ISBN-13: 978-0-321-73863-9  
ISBN-10: 0-321-73863-2

For a complete list of titles, please visit [www.pearsonhighered.com/math](http://www.pearsonhighered.com/math)

ALWAYS LEARNING

PEARSON

# Contributed Paper Sessions

Thursday, August 4, through Saturday, August 6

For full descriptions of the Contributed Paper Sessions, go to  
<http://www.maa.org/mathfest/cps.html>.

## First-Year Seminar/First-Year Experience Mathematics Courses

Jon L. Johnson, Elmhurst College; Cheryl J. McAlister, Southeast Missouri State University  
 Thursday, August 4, 1:00 p.m. – 5:20 p.m., Elkhorn D

## Fostering, Supporting, and Propagating Math Circles for Students and Teachers

Tatiana Shubin, San Jose State University; James Tanton, St. Mark's School

Session 1, Thursday, August 4, 8:30 a.m. – 10:30 a.m., Elkhorn A

Session 2, Friday, August 5, 8:30 a.m. – 10:05 a.m., Elkhorn A

Discussion Session, Friday, August 5, 10:10 a.m. – 10:30 a.m., Elkhorn A

## Geometry-Topics That Engage Students

Sarah Mabrouk, Framingham State University

Session 1, Friday, August 5, 8:30 a.m. – 10:30 a.m., Elkhorn B

Session 2, Friday, August 5, 1:00 p.m. – 4:00 p.m., Elkhorn B

## The History of Mathematics and Its Uses in the Classroom

Joel Haack, University of Northern Iowa; Pamela L. Peters, University of Wisconsin Platteville; Pam Crawford, Jacksonville University; Ximena P. Catepillan, Millersville University of Pennsylvania

Session 1, Thursday, August 4, 3:30 p.m. – 5:30 p.m., Elkhorn A

Session 2, Saturday, August 6, 8:30 a.m. – 11:30 a.m., Elkhorn A

## Know More, Teach Better? Content Knowledge for Secondary Teaching and Above

Cindy Traub, Vincent Kieftenbeld, Adam Weyhaupt, Southern Illinois University, Edwardsville

Saturday, August 6, 1:00 p.m. – 3:40 p.m., Elkhorn B

## Mathematical Modeling Projects That Matter

Mike Diehl, Endicott College; Matthew Pons, North Central College; Katharine Ott, University of Kentucky

Session 1, Thursday, August 4, 8:30 a.m. – 10:10 a.m., Elkhorn B

Session 2, Thursday, August 4, 1:00 p.m. – 4:00 p.m., Elkhorn B

## Novel Ways to Incorporate Writing into Mathematics Classes

Ryan Stufflebeam, Transylvania University; Martin Montgomery, Sam Houston State University

Session 1, Friday, August 5, 8:30 a.m. – 11:30 a.m., Elkhorn C

Session 2, Saturday, August 6, 8:30 a.m. – 11:30 a.m., Elkhorn C

Session 3, Saturday, August 6, 1:00 p.m. – 4:00 p.m., Elkhorn C

## Quantitative Reasoning and Literacy: Pedagogical Strategies

Mike LeVan, Transylvania University

Friday, August 5, 1:00 p.m. – 3:20 p.m., Elkhorn C

## Recreational Mathematics: New Problems and New Solutions

Paul Coe, Dominican University; Kristen Schemmerhorn, Dominican University

Session 1, Friday, August 5, 1:00 p.m. – 4:40 p.m., Elkhorn D

Session 2, Saturday, August 6, 8:30 a.m. – 11:30 a.m., Elkhorn D

## Teaching High School Mathematics: Beautiful Lessons Found on the Scenic Route

Caren Diefenderfer, Hollins University

Saturday, August 6, 1:00 p.m. – 3:00 p.m., Elkhorn D

## Trends in Undergraduate Mathematical Biology Education

Timothy D. Comar, Benedictine University

Thursday, August 4, 1:00 p.m. – 2:40 p.m., Elkhorn C

## What I Wish I Knew the First (or Second or $n^{\text{th}}$ ) Time I Taught Statistics

Brian Gill, Seattle Pacific University; Nancy Boynton, SUNY Fredonia; Michael Posner, Villanova University

Friday, August 5, 1:00 p.m. – 3:00 p.m., Elkhorn A

## General Contributed Paper Sessions

Shawnee McMurrin, California State University, San Bernardino

GCPS #1: History and Philosophy, Thursday 8:30 a.m. – 10:15 a.m., Elkhorn C

GCPS #2: Teaching and Learning, Thursday 8:30 a.m. – 10:15 a.m., Elkhorn D

GCPS #3: Applied Mathematics, Thursday 8:30 a.m. – 10:30 a.m., Berea Room

GCPS #4: Technology and Teaching, Thursday 1:00 p.m. – 5:45 p.m., Berea Room

GCPS #5: Modeling and Applications, Friday 8:15 a.m. – 11:30 a.m., Berea Room

GCPS #6A: Assessment, Mentoring, & Outreach, Friday 1:00 p.m. – 3:30 p.m., Berea Room

GCPS #6B: Pure Mathematics 1, Friday, 3:30 p.m. – 5:00 p.m., Berea Room

GCPS #7: Pure Mathematics 2, Saturday, 8:30 a.m. – 10:30 a.m., Elkhorn B

GCPS #8: Teaching Introductory Mathematics, Saturday 8:30 a.m. – 10:00 a.m., Berea Room

GCPS #9A: Pure Mathematics 3, Saturday, 1:00 p.m. – 3:30 p.m., Elkhorn A

GCPS #9B: Interdisciplinary Topics, Saturday, 3:30 p.m. – 4:45 p.m., Elkhorn A

GCPS #10: Teaching Advanced Mathematics, Saturday 1:00 p.m. – 4:00 p.m., Berea Room

# Panels and Other Sessions

For full descriptions of Panels and Other Sessions, go to <http://www.maa.org/mathfest/panels.html>

## Teaching Mathematics with the New Tablets: iPads, Slates, and Smartphones

Thursday, August 4, 1:00 p.m. – 2:20 p.m.

Lila Roberts, Clayton State University

## Assessing Mathematics Courses for Students in Business, Education, Engineering, and Nursing

Thursday, August 4, 1:00 p.m. – 2:20 p.m.

Bonnie Gold, Monmouth University; William Martin, North Dakota State University

## Assessing Quantitative Literacy

Thursday, August 4, 2:35 p.m. – 3:55 p.m.

Aaron Montgomery, Central Washington University

## Issues for Early-Career Mathematicians in Academia

Thursday, August 4, 4:10 p.m. – 5:30 p.m.

Doug Ensley, Shippensburg University

## Undergraduate MathBio Programs Funded by NSF-UBM

Thursday, August 4, 4:10 p.m. – 5:30 p.m.

Maeve McCarthy, Murray State University

## The Future of the Mathematics Major for Pre-Service Teachers

Thursday, August 4, 2:35 p.m. – 3:55 p.m.

Martha J. Siegel, Towson University; Kenneth C. Millett, University of California, Santa Barbara

## Summer Research Programs

Friday, August 5, 3:40 p.m. – 5:00 p.m.

William Hawkins Jr., MAA and University of the District of Columbia; Robert Megginson, University of Michigan

## How to Apply for a Job

Friday, August 5, 2:00 p.m. – 3:20 p.m.

Estela A. Gavosto, University of Kansas

## Writing for MAA Journals and Magazines

Saturday, August 6, 1:00 p.m. – 2:20 p.m.

Ivars Peterson (Director of Publications and Communications, MAA); Walter Stromquist (Editor, *Mathematics Magazine*)

## Moving Up the Career Ladder in Academia

Saturday, August 6, 2:40 p.m. – 4:00 p.m.

Maeve McCarthy, Murray State University; Jacqueline Jensen, Sam Houston State University; Rebecca Garcia, Sam Houston State University; Georgia Benkart, University of Wisconsin

**Moderator:** Jacqueline Jensen, Sam Houston State University

# Be Significant

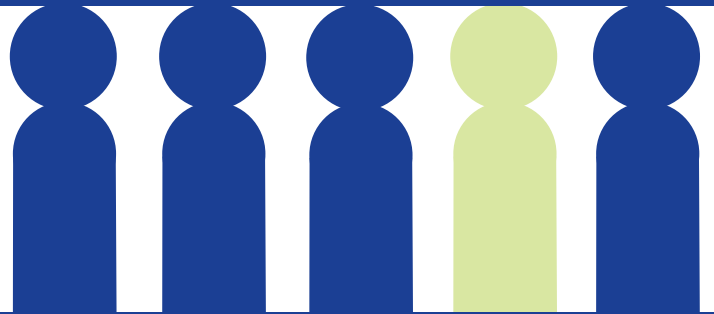

Don't be just another number.  
Join the American Statistical Association!

Members get:

- A subscription to *Amstat News*
- Online access to our premier journals
- Career opportunities
- Access to the online ASA Community—a place for like-minded statisticians to connect and share

**Student Membership is only \$15!**  
Join today at [www.amstat.org/join](http://www.amstat.org/join)

# Undergraduate Student Activities

For full descriptions of the Undergraduate Student Sessions, go to <http://www.maa.org/mathfest/students.html>.

## MAA-PME Student Reception

Wednesday, August 3, 4:30 p.m. – 5:30 p.m.

## Math Jeopardy

Wednesday, August 3, 5:30 p.m. – 6:15 p.m.

Robert Vallin, Slippery Rock University; Michael Berry, University of Tennessee

## Student Hospitality Center

Thursday, August 4, 9:00 a.m. – 5:00 p.m.

Friday, August 5, 9:00 a.m. – 5:00 p.m.

Saturday, August 6, 9:00 a.m. – 2:00 p.m.

Richard and Araceli Neal, American Society for the Communication of Mathematics

## MAA Lecture for Students

Thursday, August 4, 1:00 p.m. – 1:50 p.m.

Roger Nelsen, Lewis & Clark College, *Math Icons*

## MAA Undergraduate Student Activity

Friday, August 5, 1:00 p.m. – 1:50 p.m.

Dan Kalman, American University, *Polynomia Pasttimes*

## MAA Undergraduate Student Activity

Friday, August 5, 1:00 p.m. – 1:50 p.m.

Doug Ensley, Shippensburg University  
*Unshuffling for the Imperfect Mathematician*

## MAA Student Paper Sessions

Thursday, August 4, 8:30 a.m. – 10:25 a.m. and 2:00 p.m. – 6:15 p.m.

Friday, August 5, 8:30 a.m. – 11:45 a.m. and 2:00 p.m. – 6:15 p.m.

J. Lyn Miller, Slippery Rock University; Daluss Siewert, Black Hills State University

## Pi Mu Epsilon Student Paper Sessions

Thursday, August 4, 2:00 p.m. – 6:15 p.m.

Friday, August 5, 8:30 a.m. – 11:45 a.m. and 2:00 p.m. – 6:15 p.m.

Angela Spalsbury, Youngstown State University

## Pi Mu Epsilon Student Banquet and Awards Ceremony

Friday, August 5, 6:00 p.m. – 7:45 p.m.

## Pi Mu Epsilon J. Sutherland Frame Lecture

Friday, August 5, 8:00 p.m. – 8:50 p.m.

Margaret Wright, Courant Institute of Mathematical Sciences, *You Can't Top This: Making Things Better with Mathematics*

## MAA Ice Cream Social

Friday, August 5, 9:00 p.m. – 10:00 p.m.

## MAA Mathematical Competition in Modeling (MCM) Winners

Saturday, August 6, 9:00 a.m. – 10:30 a.m.

Ben Fusaro, Florida State University

## Student Problem-Solving Competition

Saturday, August 6, 1:00 p.m. – 2:15 p.m.

Richard Neal, American Society for the Communication of Mathematics

## Special Session: Great Talks for a General Audience: Coached Presentations by Graduate Students

Saturday, August 6, 1:00 – 5:30 p.m.

Jim Freeman, Cornell College; Rachel Schwell, Central Connecticut State University

## Open-source software

by and for the mathematical sciences community



Math software system  
[sagemath.org](http://sagemath.org)



On-line homework  
[webwork.maa.org](http://webwork.maa.org)

# Graduate Student Activities

For full descriptions of the Graduate Student Sessions, go to <http://www.maa.org/mathfest/students.html>.

### What's the Story? A Graduate Student Workshop on Creating a Research Presentation for Undergraduates

Thursday, August 4, 2:00 p.m. - 3:20 p.m.  
 Aaron Luttmann, Clarkson University;  
 Rachel Schwell, Central Connecticut State University

### Issues for Early-Career Mathematicians in Academia

Thursday, August 4, 4:10 p.m. - 5:30 p.m.  
 Doug Ensley, Shippensburg University

### Graduate Student Reception

Thursday, August 4, 5:30 p.m. - 6:30 p.m.  
 Estela A. Gavosto, University of Kansas; James Freeman, Cornell College

### Early-Career and Graduate Students PosterFest

Friday, August 5, 3:30 p.m. - 5:00 p.m.  
 Ed Aboufadel, Grand Valley State University; Aaron Luttmann, Clarkson University; Bryant Mathews, Azusa Pacific University

### How to Apply for a Job

Friday, August 5, 2:00 p.m. - 3:20 p.m.  
 Estela A. Gavosto, University of Kansas; Kim Roth, Juniata College; James Freeman, Cornell College; Estela Gavosto, University of Kansas; faculty member; industry representative

### Great Talks for a General Audience: Coached Presentations by Graduate Students

Saturday, August 6, 1:00 p.m. - 5:30 p.m.  
 Jim Freeman, Cornell College; Rachel Schwell, Central Connecticut State University

## GENERAL & INTRODUCTORY MATH BOOKS

<p><b>Paul Zorn</b>                  St. Olaf College, Northfield, Minnesota, USA                  Catalog no. K00535, 2010, 362 pp.                  ISBN 978-1-56511-155-5 \$15.50</p> <p><i>Also available as an eBook</i></p>	<p><b>Keith Devlin</b>                  Stanford University, California, USA                  Catalog no. K13065, 2011, 215 pp.                  ISBN 978-1-56511-315-5 \$25.00</p> <p><i>Also available as an eBook</i></p>	<p><b>E. Arthur Robinson, Jr. and Daniel H. Ullman</b>                  George Washington University, Washington, D.C., USA                  Catalog no. K110, 2011, 167 pp.                  ISBN 978-1-56511-330-0 \$30.00</p> <p><i>Also available as an eBook</i></p>	<p><b>David C. Kay</b>                  University of North Carolina, Asheville, USA (retired)                  Catalog no. K11005, 2011, 652 pp.                  ISBN 978-1-56511-111-1 \$55.00</p>
---	--	---	---

**Stop by our booth #25 for special offers and savings**

WWW.CRCPRESS.COM CRC Press Taylor & Francis Group

# Alder Awards

## MathFest 2011, Lexington

In January 2003 the MAA established the Henry L. Alder Award for Distinguished Teaching by a Beginning College or University Mathematics Faculty Member to honor beginning college or university faculty whose teaching has been extraordinarily successful and whose effectiveness in teaching undergraduate mathematics is shown to have influence beyond their own classrooms. Each year, at most three college or university teachers are honored with this national award.

### This year's honorees are:

- Alissa Crans**, *Loyola Marymount University*
- Sarah Eichhorn**, *University of California, Irvine*
- Sam Vandervelde**, *St. Lawrence University*

Presentations will be given by the Award recipients  
Friday, August 5, 2:00 p.m. to 3:20 p.m.

### Count Me In!

**Alissa S. Crans**, *Loyola Marymount University*  
Friday, August 5, 2:00 p.m. to 2:20 p.m.

Building and sustaining an inclusive mathematical community both locally and nationally has involved, and continues to require, the efforts of many, all working toward this common goal. It includes, among many other things, devoted mentoring, inspiring and engaging students at all levels, and increasing students' appreciation and enthusiasm for the beauty, creativity, and excitement of mathematics. While many challenges still remain, we will discuss my small efforts at "paying it forward" in my classes and in our community in gratitude for the support, advice, and encouragement I have received from the numerous mathematicians and professional organizations dedicated to increasing the number of women in the mathematical sciences.

### Lessons Learned in Year One of Calculus Coordination

**Sarah Eichhorn**, *University of California, Irvine*  
Friday, August 5, 2:30 p.m. to 2:50 p.m.

The UC Irvine Mathematics Department recently instituted a highly coordinated approach to teaching our differential and integral calculus courses, including a common final exam. From the plethora of data from over 6,000 students a year, we have found interesting and unexpected results about how our students learn calculus and what teaching strategies are most effective.

Topics presented will include assessment of placement testing, impact of class size on learning, setting expectations for rigor, writing a common final, and miscellaneous

insights on student comprehension of calculus. Obviously, many of these are deep, rich topics worth hours of discussion in their own right. This talk will present a light overview of some key insights and surprises found in the first year of coordinating our calculus instruction.

### Greater Than the Sum of its Parts

**Sam Vandervelde**, *St. Lawrence University*  
Friday, August 5, 3:00 p.m. to 3:20 p.m.

To the uninitiated it may seem that the ideal mathematics position would involve teaching smart kids at a prestigious institution, preferably with a generous complement of graders and well-equipped classrooms. Fortunately, a productive, rewarding teaching career is largely independent of all these criteria. To illustrate the sorts of factors that have actually made a significant impact upon my quality of life as a teacher we will consider Mathematical Outings, IF-AT movies, and the case of Chris. For it is in the fabulous subject we teach, the new ideas we encounter and implement, and the students whom we inspire and by whom we are challenged that teaching exceeds our expectations.

"A delightful worldwide tour of the most interesting and weirdest in math."  
—*The Daily Beast*

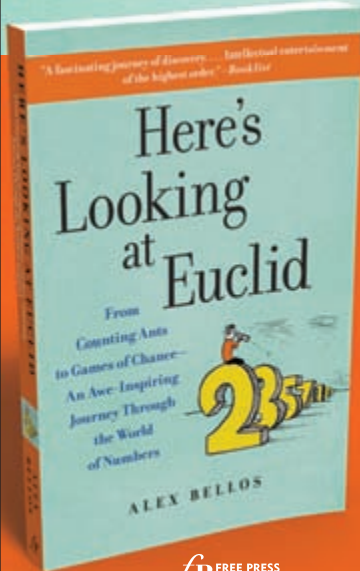

**Did you know...**

- ☞ Some ants can count the number of steps they've taken away from their anthill?
- ☞ In India there is no word for "million," and *Slumdog Millionaire* was titled *Slumdog Crorepati*?
- ☞ The Golden Ratio is the secret to a perfect smile?

You will after you read *Here's Looking at Euclid*.

Available wherever books are sold.

# SIGMAA Activities

For full descriptions of the SIGMAA Activities, go to  
<http://www.maa.org/mathfest/sigmaa.html>.

## History of Mathematics

### Contributed Paper Session: The History of Mathematics and Its Uses in the Classroom

Session 1, Thursday, August 4, 3:30 p.m. - 5:30 p.m., Elkhorn A  
 Session 2, Saturday, August 6, 8:30 a.m. - 11:30 a.m., Elkhorn A

## Math Circles for Students and Teachers

### Math Circles Demonstrations

Session 1, Thursday, August 4, 4:30 p.m. ÷ 5:30 p.m.  
 Session 2, Saturday, August 6, 1:00 p.m. ÷ 2:00 p.m.  
 Session 3, Saturday, August 6, 3:00 p.m. ÷ 4:00 p.m.

### Contributed Paper Session: Fostering, Supporting, and Propagating Math Circles for Students and Teachers

Session 1, Thursday, August 4, 8:30 a.m. - 10:30 a.m., Elkhorn A  
 Session 2, Friday, August 5, 8:30 a.m. - 10:05 a.m., Elkhorn A  
 Discussion Session, Friday, August 5, 10:10 a.m. - 10:30 a.m., Elkhorn A

## Math Wrangle

Saturday, August 6, 10:00 a.m. ÷ 11:30 a.m., Heritage 2

## Mathematical and Computational Biology

### Contributed Paper Session: Trends in Undergraduate Mathematical Biology Education

Thursday, August 4, 1:00 p.m. - 2:40 p.m., Elkhorn C

## Environmental Mathematics

### Guest Lecture

Thursday, August 4, 4:00 p.m. ÷ 4:45 p.m.

### Business Meeting

Thursday, August 4, 4:45 p.m. ÷ 5:30 p.m.

### Bus Trip: The Environment & Hydrology of the Lexington Region

Saturday, 1:30 p.m. ÷ 5:30 p.m.

Leader: Peter Idstein, Dept. of Earth & Environ. Science, Univ. of Kentucky

## Mathematics Instruction Using the Web

### Business Meeting

Friday, August 5, 5:00 p.m. - 6:00 p.m.

## Guest Lecture

Andrew Bennett, Kansas State University  
 Friday, August 5, 5:00 p.m. - 6:30 p.m.

## Touchable Math with HTML5

## Philosophy of Mathematics

### Reception

Thursday, August 4, 5:00 p.m. ÷ 5:30 p.m.

### Guest Lecture

Neil Tennant, Department of Philosophy, Ohio State University  
 Thursday, August 4, 5:30 p.m. ÷ 6:30 p.m.

## Quantitative Literacy

### Panel: Assessing Quantitative Literacy

Thursday, August 4, 2:35 p.m. ÷ 3:55 p.m.

## Research in Undergraduate Mathematics Education

### Designing Instruction That Builds on Students' Ways of Reasoning in Linear Algebra

Session 1, Thursday, August 4, 3:40 p.m. - 5:00 p.m.  
 Session 2, Friday, August 5, 3:40 p.m. - 5:00 p.m.

## Statistics Education

### Contributed Paper Session: What I Wish I Knew the First (or Second or $n^{\text{th}}$ ) Time I Taught Statistics

Friday, August 5, 1:00 p.m. - 3:00 p.m., Elkhorn A

## Teaching Advanced High School Mathematics

### Contributed Paper Session: Teaching High School Mathematics: Beautiful Lessons Found on the Scenic Route

Saturday, August 6, 1:00 p.m. - 3:00 p.m., Elkhorn D

### Business Meeting

Saturday, August 6, 5:00 p.m. - 6:00 p.m.

# Minicourses

## MINICOURSE 1

### A Dynamical Systems Approach to the Differential Equations Course

Part 1, Thursday, August 4, 1:00 p.m. – 3:00 p.m.

Part 2, Friday, August 5, 1:00 p.m. – 3:00 p.m.

This minicourse will give an overview of the Boston University Differential Equations Project, originally funded by the National Science Foundation. The BU project involves a complete redesign of the sophomore-level ODE course. It includes more emphasis on qualitative and geometric methods as well as the incorporation of technology and numerical methods throughout. This minicourse will be useful to college instructors wishing to restructure their ODE courses. Participants need to bring computers or graphing calculators.

**Presenter:** Paul Blanchard, Boston University

## MINICOURSE 2

### Alternatives to Traditional Grading to Enhance Student Learning

Part 1, Thursday, August 4, 1:00 p.m. – 3:00 p.m.

Part 2, Friday, August 5, 1:00 p.m. – 3:00 p.m.

The first part of this course covers using holistic grading rubrics rather than standard points allocation. These rubrics provide greater consistency in grading, give better feedback for students, and result in more efficiency for instructors. The rubrics are extremely flexible, allowing their use on various types of problems and assignments. The second half covers a “points-free” approach to running a course. We explain how to implement this design, while also discussing the deep-learning benefits inherent in this method. In both parts, we work with hands-on examples to see directly how these assessment tools are easily applied. Materials will be provided.

**Presenters:** Michael A. Brilleslyper and Beth Schaubroeck, U.S. Air Force Academy

## MINICOURSE 3

### An In-Class Role-Playing Game for Quantitative Literacy: Social Security, 1935

Part 1, Friday, August 5, 3:30 p.m. – 5:30 p.m.

Part 2, Saturday, August 6, 3:30 p.m. – 5:30 p.m.

Participants will play and learn to be game-masters for a role-playing game we have developed for quantitative literacy (QL) classes, based on the 1935 legislation that founded Social Security in the United States. Players (as representatives in the U.S. House) present quantitative arguments for or against including pensions and/or

insurance for disability, unemployment, or health care in the legislation. All of these provisions were under consideration at that time. QL topics include regression, histograms, mean vs. median, inflation, and estimation skills. This is part of an NSF grant to extend the “Reacting to the Past” role-playing pedagogy to STEM fields. Participants are encouraged to bring laptop computers to the session.

**Presenters:** John Curran and Andrew M. Ross, Eastern Michigan University

## MINICOURSE 4

### Recruiting Students to Take More Mathematics Courses and to Be Math Majors

Part 1, Thursday, August 4, 3:30 p.m. – 5:30 p.m.

Part 2, Saturday, August 6, 1:00 p.m. – 3:00 p.m.

We will discuss some principles and specific activities we have used to increase the number of students taking mathematics courses and becoming math majors. Principles include creating a culture of “Math is cool!”; exposing students to careers and opportunities available to those who study mathematics, and being proactive in your efforts. Specific activities include a “Careers in Mathematics” seminar, a freshman/sophomore class titled “Intro to Being a Math Major,” the creation of a student advisory council, a big-screen HDTV display with a PowerPoint presentation about mathematics, a set of math T-shirts, and the “When Will I Use Math” website.

**Presenter:** Michael Dorff, Brigham Young University

## MINICOURSE 5

### Elementary Mathematics in Architecture

Part 1, Thursday, August 4, 3:30 p.m. – 5:30 p.m.

Part 2, Saturday, August 6, 1:00 p.m. – 3:00 p.m.

This minicourse will give examples of basic mathematics, chiefly elementary geometry, algebra, and trigonometry, properties of vectors, and coordinate geometry used in architecture. The architecture that is informed includes classical Greek architecture, the Roman arch, the dome of the Cathedral of Florence, and the design (by Arup) of the concourse beams and the roof vaults (by Utzon) of the Sydney Opera House. Possible other topics include: hanging chains and rising domes: from Hooke to the dome of St. Peter’s Basilica; calculus and the weights of the domes of the Pantheon and the Hagia Sophia, and the shape of the ideal arch.

**Presenter:** Alexander J. Hahn, University of Notre Dame



# Short Course

*The MAA MathFest Short Course is presented in honor of William F. Lucas.*

## Trends in Mathematical Biology

August 2 & 3, 9:00 a.m. - 5:00 p.m., Bluegrass Room, Salon A, Hilton Hotel

**Organizers:** Holly Gaff, St. John's University/College of St. Benedict; Jennifer Gallovich, Old Dominion University

And your last biology course was ... when? Many of us have little (or woefully outdated) background in the biological sciences; however, the list of enrollees in our courses will include students whose primary interests are in biology, environmental science, the allied health sciences, and so on. In the last decade or so, there has been a great deal of energy directed to the transformation of life science education through the integration of mathematical and computational content—but how will we implement these approaches in the mathematics classroom? Can we find common ground (or common curriculum!) with our colleagues in the biological sciences?

The purpose of this short course is to introduce participants to a range of current topics in mathematical biology. Moreover, mathematical biology has exploded in recent years, developing new perspectives on both parent disciplines by combining biological and mathematical ideas and tools in sometimes unexpected ways. So we also hope that this short course will begin a continuing conversation on how we might integrate such modern applications into the undergraduate mathematics program.

This short course will consist of seven invited presentations taking place over two days. Each presenter will discuss his or her own research and offer suggestions as to how

the topic might be included in various mathematics and/or biology courses. We will conclude with a group discussion of the challenges and opportunities of implementation in the undergraduate mathematics curriculum. All participants will be encouraged to suggest particular ways the short course topics might be incorporated into new or existing courses and how we might build a platform for further conversation with colleagues in the life sciences.

We expect a lively discussion!

### PRESENTERS:

**Janet Best**, *Ohio State University and Mathematical Biosciences Institute*

*Planting Seeds by Mining the Mind: Examples from Mathematical Neuroscience Get Students Thinking*

**Philip Crowley**, *University of Kentucky*

*Some Applications of Game Theory in Evolutionary Ecology*

**Renee Fister**, *Murray State University*

*Can Math Cure Cancer?*

**Holly Gaff**, *Old Dominion University*

*Ticks Can Give You More Than the Creeps—Mathematical Modeling of Tick-Borne Diseases*

**Lou Gross**, *Director, NIMBioS, and University of Tennessee Knoxville*

*Drugs, Sex, and Rock 'n' Roll: Biology Examples to Motivate Undergraduate Math Classes*

**Terrell Hodge**, *Western Michigan University*

*Tree Tapping and Network Mapping: Adventures in, and Applications of, Modern Discrete Mathematics*

**Winfried Just**, *Ohio University*

*Modeling the Dynamics of Biological Networks*

## MINICOURSE 6

### The Mathematics of Folding & Unfolding

Part 1, Friday, August 5, 3:30 p.m. – 5:30 p.m.

Part 2, Saturday, August 6, 3:30 p.m. – 5:30 p.m.

How many ways are there to flatten a cube? How can you cut out block letters for a whole word all at once with one straight scissors cut? Can every polygon fold to a polyhedron? These questions can be answered through the mathematics of folding and unfolding. We will study the mathematics underlying origami and unfolding of

polyhedra, introducing fascinating combinatorial and geometric concepts that let students supplement their mathematical understanding with physical intuition. They can check conjectures and proofs by manipulating paper in their hands. These problems reach the frontiers of current mathematical research and provide accessible unsolved problems. Participants will fold, cut, and tape paper to experience how tactile manipulation leads to greater understanding of the folding theorems discussed.

**Presenter:** Joseph O'Rourke, Smith College

# Workshops and Other Sessions

For full descriptions of Workshops and Other Sessions, go to <http://www.maa.org/mathfest/othermath.html>.

## Judging High School Contests

Wednesday, August 3, 4:00 p.m. – 5:30 p.m.  
Ben Fusaro, Florida State University

## What's the Story? A Graduate Student Workshop on Creating a Research Presentation for Undergraduates

Thursday, August 4, 2:00 p.m. – 3:20 p.m.  
Aaron Luttmann, Clarkson University; Rachel Schwell, Central Connecticut State University

## MAA Section Officers Meeting

Thursday, August 4, 3:30 p.m. – 5:00 p.m.

## Poster Session: Celebrating AWM Student Chapters

Friday, August 5, 1:00 p.m. – 2:30 p.m.  
Maia Averett, Mills College

## Early-Career and Graduate Students PosterFest

Friday, August 5, 3:30 p.m. – 5:00 p.m.  
Ed Aboufadel, Grand Valley State University; Aaron Luttmann, Clarkson University; Bryant Mathews, Azusa Pacific University

## Math Circles Demonstrations

Session 1, Thursday, August 4, 4:30 p.m. – 5:30 p.m.  
Session 2, Saturday, August 6, 1:00 p.m. – 2:00 p.m.  
Session 3, Saturday, August 6, 3:00 p.m. – 4:00 p.m.  
James Tanton, St. Mark's School; Tatiana Shubin, San Jose State University

## Designing Instruction That Builds on Students' Ways of Reasoning in Linear Algebra

Session 1, Thursday, August 4, 3:40 p.m. – 5:00 p.m.  
Session 2, Friday, August 5, 3:40 p.m. – 5:00 p.m.  
Sean Larsen, Portland State University; Stacy Brown, Pitzer College; Natasha Speer, University of Maine; Karen Marrongelle, Portland State University  
**Presenters:** Megan Wawro, San Diego State University; George Sweeney, San Diego State University; Michelle Zandieh, Arizona State University; Christine Larson, Vanderbilt University

## MAA Prize Session

Friday, August 5, 11:00 a.m. – 12:00 a.m.

## Alder Award Session

Friday, August 5, 2:00 p.m. – 3:20 p.m.

## Presentations by the Alder Award Recipients

2:00 p.m. Alissa Crans, Loyola Marymount University  
2:30 p.m. Sarah Eichhorn, University of California, Irvine  
3:00 p.m. Sam Vandervelde, St. Lawrence University

## Math Wrangle

### Hosted by SIGMAA Math Circles

Saturday, August 6, 10:00 a.m. – 11:30 a.m., Heritage 2

## MAA Business Meeting

Saturday, August 6, 11:00 a.m. – 11:50 a.m.

## Great Talks for a General Audience: Coached Presentations by Graduate Students

Saturday, August 6, 1:00 p.m. – 5:30 p.m.  
Jim Freeman, Cornell College; Rachel Schwell, Central Connecticut State University

### Natural Resource Modeling

is an international journal devoted to mathematical modeling of natural resource systems. It reflects the conceptual and methodological core that is common to model building throughout disciplines including such fields as forestry, fisheries, economics and ecology.

Read a sample issue and recommend the journal to your library at

[wileyonlinelibrary.com/journal/nrm](http://wileyonlinelibrary.com/journal/nrm)

 WILEY  ONLINE LIBRARY



# Exhibitors

Exhibit Hall: Lexington Convention Center, Level 1

Wednesday, August 3: 6:00 p.m. – 7:30 p.m.

Thursday, August 4: 9:00 a.m. – 5:00 p.m.

Friday, August 5: 9:00 a.m. – 5:00 p.m.

Saturday, August 6: 9:00 a.m. – 2:00 p.m.

## American Mathematical Society (AMS)

The American Mathematical Society was founded in 1888 to further the interests of mathematical research and scholarship, and serves the national and international communities. The AMS publishes books, journals (electronic and print), and MathSciNet—the Mathematical Reviews Database. Our top-tier research publications span the entire spectrum of pure and applied mathematics for professionals, graduate students, and advanced undergraduates. For more information or to purchase AMS publications, go to [www.ams.org/bookstore](http://www.ams.org/bookstore).

## Association for Women in Mathematics

The Association for Women in Mathematics (AWM) is a non-profit organization founded in 1971. The purpose of the Association for Women in Mathematics is to encourage women and girls to study and to have active careers in the mathematical sciences, and to promote equal opportunity and the equal treatment of women and girls in the mathematical sciences. AWM currently has more than 3000 members (women and men) representing a broad spectrum of the mathematical community — from the United States and around the world!

## Cambridge University Press

Cambridge's publishing in books and journals combines state-of-the-art content with the highest standards of scholarship, writing, and production. Visit our stand to browse new titles, available at a 20% discount, and to pick up sample issues of our journals. Visit our website to see everything we do: [www.cambridge.org/us/](http://www.cambridge.org/us/).

## Casio

### CASIO EDUCATION: PUT VALUE BACK IN THE EQUATION

Schools, educators and administrators have a choice. When you choose CASIO for your technology solution, the decision is backed by industry's best savings, FREE support programs and the advance functionality of our products. For more information, visit [www.casioeducation.com](http://www.casioeducation.com) or call 1-800-582-2763.

## CRC Press - SPONSOR

CRC Press is the publisher of well-known mathematics titles under the imprint of Chapman & Hall/CRC. With the acquisition of A K Peters, we have considerably strengthened our program across the entire field of mathematics. Our featured titles this year are: *Mathematics Education for a New Era*, Keith Devlin, *You Can Count on Monsters*, Richard Schwartz, *Differential Geometry of Curves and Surfaces*, Tomas Banchoff, *Understanding Real Analysis*, Paul Zorn, *Mathematics for the Environment*, Martin Walter, *A Mathematical Look at Politics*, Arthur Robinson and Daniel Ullman; and *CRC Standard Mathematical Tables and Formulae*, 32nd Edition, Daniel Zwillinger.

## Fit to a Tee

We supply academic and professional t-shirts at all types of educational and professional conferences. Unlike our few competitors who carry only their own merchandise, we carry the best designs of many different creative companies and individuals in addition to our designs. It gives us a much

more varied and interesting look and choices for the attendees. Please visit us at booth #15.

## Hawkes Learning Systems - SPONSOR

Hawkes Learning Systems has been specializing in mathematics for over 30 years. Its unique approach to mastery learning motivates students to excel in math. The software provides students with interactive instruction, step-by-step tutorials, unlimited practice, error-specific feedback for incorrect answers, and mastery-based homework assignments. Hawkes is the solution for your students' success!

## Make Textbooks Affordable

Make Textbooks Affordable is a non-profit student campaign to reduce textbook costs by promoting affordable alternatives like open-access textbooks. The campaign is a project of the Student PIRGs, which is a national network of state-based student groups that work to solve problems related to the environment, consumer protection, and government reform. <http://www.studentpirgs.org/open-textbooks>.

## MAA American Mathematics Competitions

The mission of the MAA Competitions is to increase interest in mathematics and to develop problem solving through a fun competition. Students gain the opportunity to learn and achieve through competition with students in their school and from around the world. Teachers and schools benefit from the chance to challenge students with interesting mathematical questions that are aligned with curriculum standards at all levels of difficulty.

# Exhibitors (continued)

Exhibit Hall: Lexington Convention Center, Level 1

Wednesday, August 3: 6:00 p.m. – 7:30 p.m.

Thursday, August 4: 9:00 a.m. – 5:00 p.m.

Friday, August 5: 9:00 a.m. – 5:00 p.m.

Saturday, August 6: 9:00 a.m. – 2:00 p.m.

## MAA-Publications

The Mathematical Association of America (MAA) is the largest professional society that focuses on mathematics accessible at the undergraduate level. Books, journals, DVDs, and professional development programs are just a few of the offerings available from the MAA. Place an order during MathFest this year and receive free shipping and handling and discounts below member prices. The MAA is also absorbing the sales tax on meeting orders.

## MAA-Membership

Do you have a great t-shirt idea? Stop by the MAA Membership booth to see how you can enter to design our 2012 t-shirt. While you're there, check out the winning 2011 design along with our youth t-shirts designed by MAA author John DePillis.

## Madison Convention & Visitors Bureau

Greater Madison Convention & Visitors Bureau welcoming Mathematical Association of America's MathFest 2012 at Monona Terrace Community & Convention Center [www.mononaterrace.com](http://www.mononaterrace.com). Visit our booth #41 and sign up for our visitor e-news to register to win a complimentary MathFest 2012 registration & accommodations package. Visit [www.visitmadison.com](http://www.visitmadison.com) for complete Madison information.

## Maplesoft

Maplesoft's core technology is the world's most advanced symbolic computation engine, which is the foundation for all of its products, including MapleT, the technical computing and documentation environment; Maple T.A., a web-based system for creating and assessing online

tests and assignments; and the Maple T.A. MAA Placement Test Suite which offers the renowned Mathematical Association of America (MAA) placement tests in an online environment.

## Math for America - SPONSOR

Math for America (MfA) is a private nonprofit organization with a mission to improve mathematics education in US public secondary schools. MfA offers Fellowships for new and experienced teachers and school leaders, including: the MfA Fellowship, which aims to increase the number of mathematically talented individuals entering the teaching profession; the MfA Early Career Fellowship and the MfA Master Teacher Fellowship, which support outstanding mathematics teachers already in the classroom; and the MfA School Leaders Fellowship, which is designed to support experienced mathematics teachers who have moved into administrative positions and oversee mathematics instruction in their schools.

## Mathematical Sciences Publishers/ Involve – A Journal of Mathematics

Mathematical Sciences Publishers (MSP) is a nonprofit organization located at UC Berkeley, run for and by mathematicians, and dedicated to publishing academic journals and books at the lowest cost but highest quality. MSP is the home of long-standing journals such as *Geometry & Topology* and *Algebraic & Geometric Topology*, as well as *Involve - A Journal of Mathematics*. *Involve* is dedicated to showcasing and encouraging high-quality mathematical research involving students (at all levels). For more information, visit <http://mathscipub.org>.

## McGraw-Hill Higher Education

McGraw-Hill Higher Education is a leading innovator in the development of 21st century teaching and learning solutions for postsecondary and higher education markets worldwide. We empower and prepare professionals and students through a comprehensive range of traditional and digital education content and tools to connect, learn and succeed.

## National Association of Math Circles - SPONSOR

The National Association of Math Circles provides a community for Math Circles and similar programs via a website <http://mathcircles.org>. The fun and interactive website includes a database of Math Circles worldwide, a wiki started by Sam Vandervelde's *Circle in a Box Math Circle* book, a Math Circle Problem and Lesson Collection, as well as a developing forum for discussion of Math Circle-related ideas. Visit our booth to learn more or attend one of the SIGMAA-MCST sessions to learn more about Math Circles.

## National Security Agency (NSA)

The NSA/CSS core missions are to protect U.S. national security systems and to produce foreign signals intelligence information. The Information Assurance mission confronts the formidable challenge of preventing foreign adversaries from gaining access to sensitive or classified national security information. The Signals Intelligence mission collects, processes, and disseminates intelligence information from foreign signals for intelligence and counterintelligence purposes and to support military

# Exhibitors (continued)

Exhibit Hall: Lexington Convention Center, Level 1

Wednesday, August 3: 6:00 p.m. – 7:30 p.m.

Thursday, August 4: 9:00 a.m. – 5:00 p.m.

Friday, August 5: 9:00 a.m. – 5:00 p.m.

Saturday, August 6: 9:00 a.m. – 2:00 p.m.

operations. This Agency also enables Network Warfare operations to defeat terrorists and their organizations at home and abroad, consistent with U.S. laws and the protection of privacy and civil liberties.

## Only In Kentucky

Only In Kentucky is the place to get all your game day gear and more. You can find everything you will ever need to deck yourself out from head to toe with the latest University of Kentucky apparel. We feature a large assortment of men's and women's t-shirts, jerseys, sweatshirts and hats. Only In Kentucky also carries a large selection of Kentucky Proud foods from Makers Mark Bourbon Balls to Sweet Dillies Pickles! Only In Kentucky makes it easy to get all your UK apparel, merchandise and gifts all in one spot and conveniently located just across the street from Rupp Arena.

## Pearson

As a leading publisher in mathematics, we are pleased to present the most innovative, easy-to-use, well-integrated online teaching and learning tools available for your courses. Browse our booth to find the perfect solution for your classes, your students, and you.

## Robert Carden Art

Robert Carden is a self-taught artist who creates original hand-drawn and hand-designed pen and inks and collages. It is all mathematical and geometrical in nature and includes fractals, perspective drawings and more. None of it is computer generated.

## Smart Scholarship Program

The Science, Mathematics And Research for Transformation (SMART) Scholarship for Service Program is an opportunity for students pursuing an undergraduate or graduate degree in Science, Technology, Engineering, and Mathematics (STEM) disciplines to receive a full scholarship and be employed upon degree completion at a DoD research facility. Scholarships awarded include a cash award of \$25,000 to \$41,000 a year, full tuition, required fees, health insurance allowance, and book allowance. The SMART Program will allow individuals to acquire an education in exchange for a period of employment with the Department of Defense. The program is intended for citizens of the United States; students must be at least 18 years of age to be eligible for an award. Please visit [smart.asee.org](http://smart.asee.org) for more information

## Society of Actuaries

The Society of Actuaries (SOA) is the largest professional organization dedicated to serving approximately 22,000 actuarial members and the public in the United States, Canada and worldwide. The SOA's vision is for actuaries to be the leading professionals in the measurement and management of risk. To learn more please visit [www.soa.org](http://www.soa.org). The Be an Actuary website, [www.beanactuary.org](http://www.beanactuary.org), is designed to inspire high school students and career changers, as well as their influencers, to consider actuarial science as a career.

## Springer

Visit the Springer booth and get further acquainted with an abundant selection of top-notch titles by award-winning authors and highly cited journals in all areas of mathematics. Books specially discounted!

## Taylor and Francis

Building on two centuries' experience, Taylor & Francis has grown rapidly over the last two decades to become a leading international academic publisher. We operate from a network of 20 global offices, including New York, Philadelphia, Oxford, Melbourne, Stockholm, Beijing, New Delhi, Johannesburg, Singapore and Tokyo. The Taylor & Francis Group publishes more than 1,500 journals, over 30 of which are mathematics titles, and around 1,800 new books each year, with a books backlist in excess of 20,000 specialist titles.

## Texas Instruments

Supporting educators' passion for teaching, TI's research-based technology for instruction and assessment, curricular materials and professional development combine to provide essential elements for greater student achievement in math and science. The TI-Nspire™ learning handhelds and computer software build on proven graphing technology and further enable students to explore multiple representations of concepts on a single screen. The TI-Navigator™ classroom learning system engages each student and provides real-time assessment of student understanding. Visit [education.ti.com](http://education.ti.com).

# Exhibitors (continued)

Exhibit Hall: Lexington Convention Center, Level 1

Wednesday, August 3: 6:00 p.m. – 7:30 p.m.

Thursday, August 4: 9:00 a.m. – 5:00 p.m.

Friday, August 5: 9:00 a.m. – 5:00 p.m.

Saturday, August 6: 9:00 a.m. – 2:00 p.m.

## University of California, Riverside, Mathematics Department

The University of California at Riverside, Mathematics Department is pleased to join this event. With 39 Ph.D. programs, 37 Master's programs and 17 state teaching credential programs, UCR offers a wide range of opportunities for graduate study and research. As the fastest growing university in the University of California system we have constructed new, state-of-the-art buildings and developed new graduate programs to provide unprecedented opportunities for our graduate students. We will have a representative on hand to give you information about the UCR Mathematics Graduate programs in Pure and Applied Math as well as a representative from the UCR Statistics Department. A current graduate student will also be available to talk to you more in depth about what it means to be a member of the mathematics department and answer any questions you may have.

## University of Kentucky-Mathematics Department

The University of Kentucky Department of Mathematics plays a central role in the education, research and service missions of the University of Kentucky. Our department offers bachelors', masters', and doctoral degrees. We have an active undergraduate program that offers a Bachelor of Arts and Bachelor of Science degree in Mathematics and Mathematical Sciences. The Department collaborates with the Department of Economics in the Gatton College of Business to offer the Mathematical Economics major. Our graduate program enrolls about 60 graduate students and our graduates

move on to academic tenure-track positions, post-doctoral positions and to government and industry. Stop by booth #19 to learn a little bit more about our Math program!

## W.H. Freeman & Co.

W.H. Freeman publishes high-quality textbooks and media in mathematics and statistics. Visit booth #38 to learn about our new and popular titles, including Rogawski *Calculus*, COMAP *For All Practical Purposes*, Shifrin *Linear Algebra*, Sowder *Reconceptualizing Mathematics*, Moore *Essential Statistics*, Larose *Discovering Statistics*, and Kokoska *Introductory Statistics*, among many others. Stop by to also see demonstrations of our innovative media and online homework systems, including CalcPortal, MathPortal, StatsPortal, and the new Statistics Video Tool Kit.

## WebAssign - SPONSOR

WebAssign, the independent online homework and assessment solution, continues to innovate. With robust new tools and pre-coded questions from over 250 leading math and statistics titles from every major publisher (including open text solutions), WebAssign is your indispensable partner in education. WebAssign's new patent-pending Answer Evaluation and Grading Engine is powerful new functionality that interprets and evaluates student responses mathematically, grading answers just like you do. Visit [www.webassign.net](http://www.webassign.net) or stop by our booth to learn more.

## John Wiley & Sons, Inc.

Founded in 1807, John Wiley & Sons, Inc. is an independent, global publisher of print and electronic products. Wiley specializes in scientific and technical books, journals, textbooks and education materials, and professional and consumer books and subscription services. <http://www.wiley.com>.

## Worldwide Center of Mathematics

We are here exhibiting our revolutionary, multimedia calculus textbook series: Worldwide Differential, Integral, and Multivariable Calculus. The textbooks are produced as PDFs, which allows us to add a whole host of new features right in the text, including full-length video lectures, shorter video tutorials, step-by-step video solutions, hyperlinked cross-references for easy navigation, and animated/interactive graphs. We also are developing several new digital mathematics textbooks and have released two apps for the Apple app store. Please stop by our booth (#9) to check out our interactive exhibit where you can test all of our products for yourself!

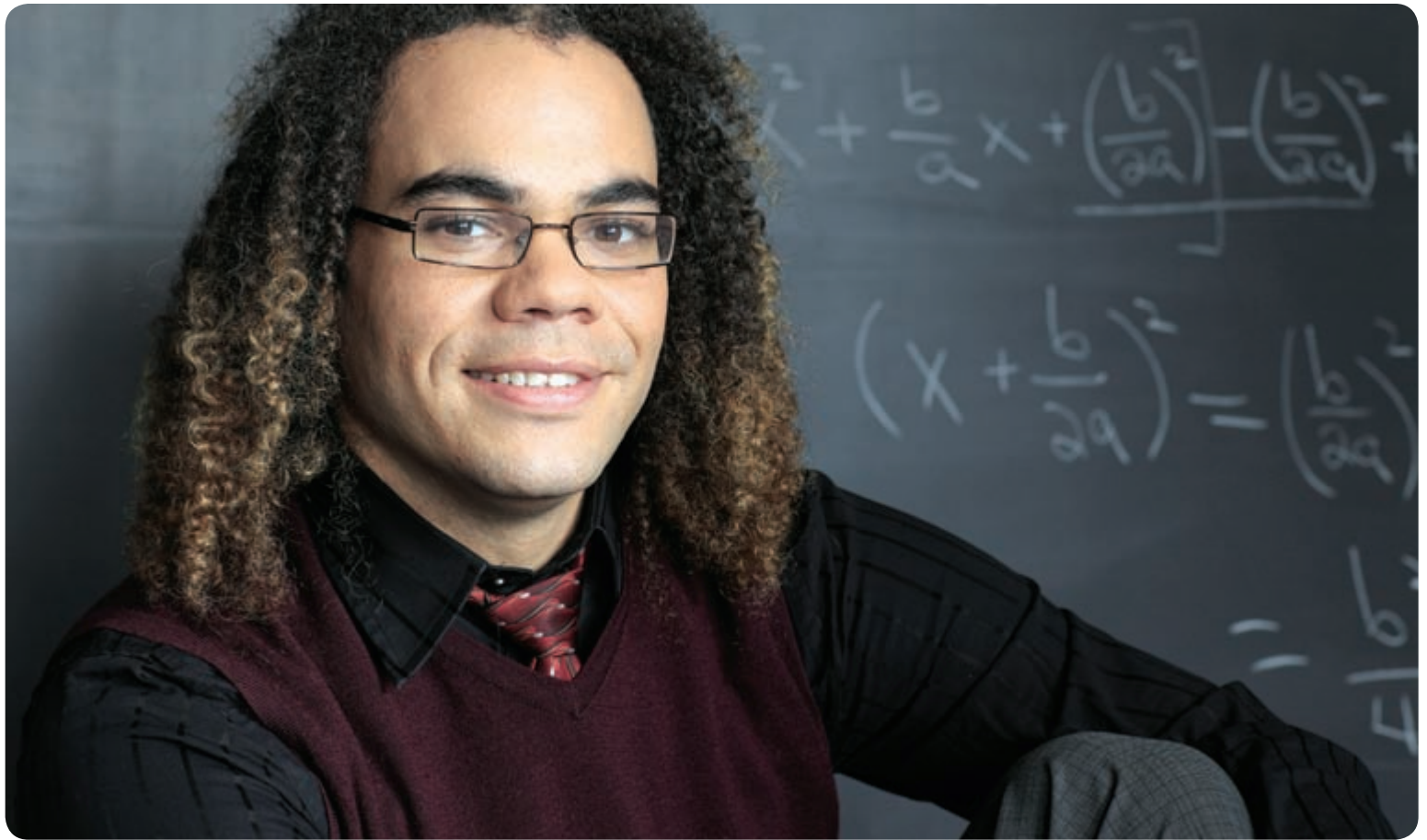

**“If you love math,  
this is the solution.”**

**Join the Math for America corps.**

If you'd like to inspire the next generation of mathematics students, Math for America could be your best career path. It's a simple formula - you teach math in a public secondary school, and we invest in your future. Whether you're just thinking about starting a career in teaching math or already experienced in the classroom, each of our Fellowship programs provide the financial and professional development support to ensure you become part of our nation's mathematics literacy solution.

Learn more about MfA at  
[www.mathforamerica.org](http://www.mathforamerica.org)

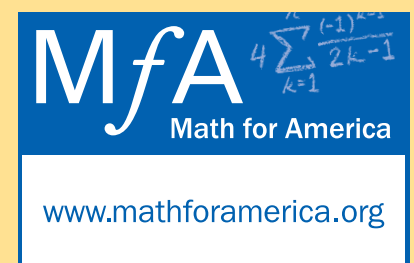

# Map of Lexington

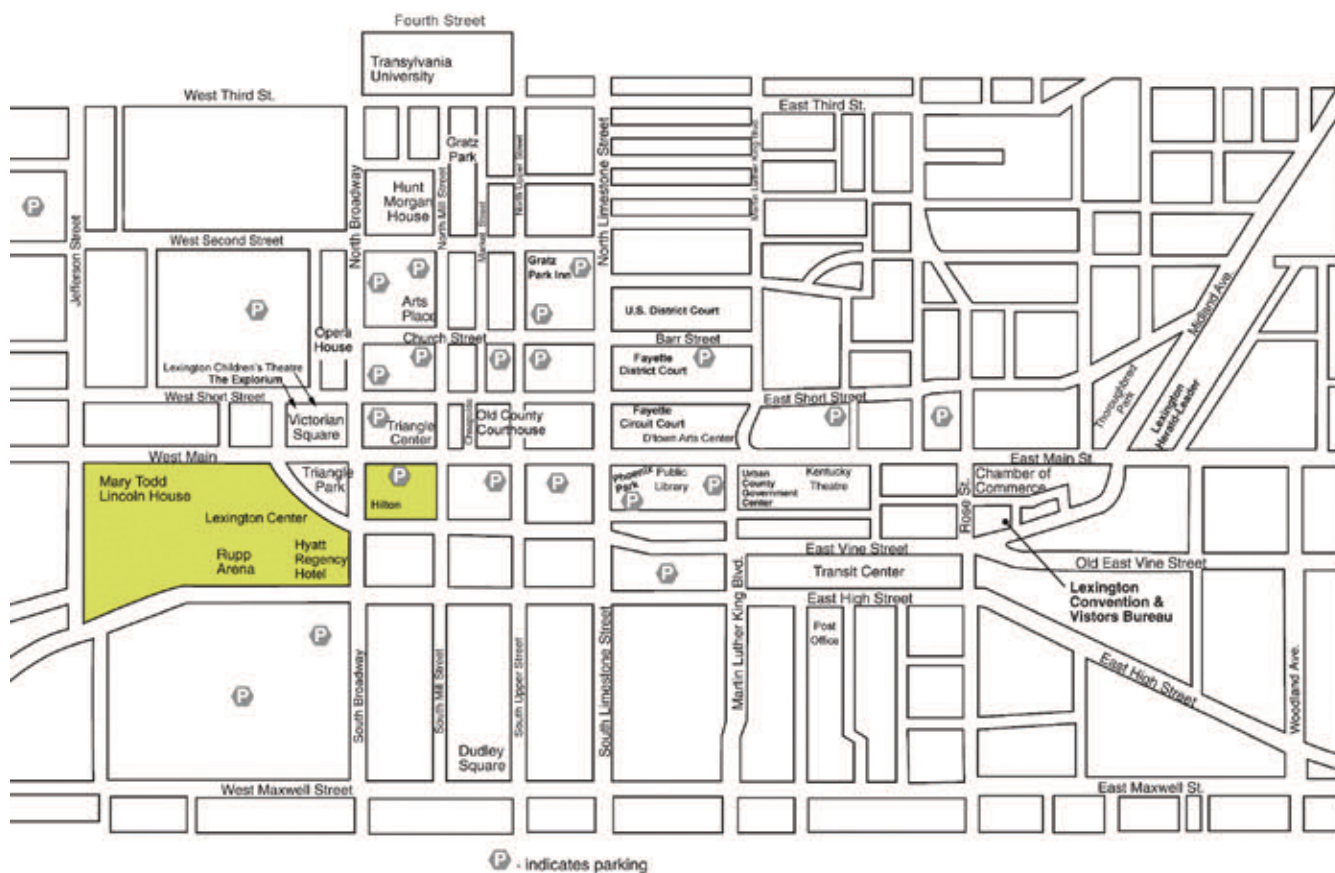

## Complimentary Wi-Fi Access

### Exhibit Hall

Lexington Convention Center  
Level 1

Thursday, August 4: 9:00 a.m. – 5:00 p.m.  
Friday, August 5: 9:00 a.m. – 5:00 p.m.  
Saturday, August 6: 9:00 a.m. – 2:00 p.m.

Provided by the Mathematical Association of America



# 3 books. 3 days.

## Lowest Price Ever!

Books value \$30 –\$46.

Available only at MAA MathFest.

August 4: Special Sale Title for \$4!

August 5: Special Sale Title for \$5!

August 6: Special Sale Title for \$6!



Titles announced daily in the exhibit hall and on Twitter at 3:14 P.M.  
Follow MAA on Twitter @maanow (#MAAthFest11) for titles.



## MAA SUMMER SALE

### Buy Today!

New MAA t-shirt designs now available!

Be person no. **(9th Fibonacci Number)** to make a purchase and win a special prize.

Exhibit Hall—Booths 8 and 9

Also available are our lanyards, travel mugs, polos and much more! Stop by for a look at our complete merchandise line.



	8:00 a.m.	9:00 a.m.	10:00 a.m.	11:00 a.m.	12:00 p.m.	1:00 p.m.	2:00 p.m.
<b>Registration</b>	<b>REGISTRATION</b> (MathFast 2011 Registration is located in the Lexington Convention Center on Level 1)						
<b>Exhibit Hall</b>	<b>EXHIBIT HALL/STUDENT HOSPITALITY CENTER</b> (Located in the Heritage Ballroom East Level 1)						
<b>Heritage Ballroom, Center</b>		AMS/MAA JOINT INVITED ADDRESS - POLYNOMIAL DYNAMICS: Conjugacy and Combinatorics by Laura DeMarco	MAA INVITED ADDRESS: Planting your Roots in the Natural Numbers by Edward Burger	EARLE RAYMOND HEDRICK LECTURE: From Right-Angled Triangles to Algebraic Curves by Manjul Bhargava		MAA LECTURE FOR STUDENTS: Math Icons by Roger Nelsen	
<b>Heritage Ballroom 2 (LC)</b>						INVITED PAPER SESSION	
<b>Heritage Ballroom 3 (LC)</b>							INV Offered through
<b>Elkhorn A (LC)</b>		CONTRIBUTED PAPER SESSION: Fostering, Supporting, and Propagating Math Circles for Students and Teachers					
<b>Elkhorn B (LC)</b>		CONTRIBUTED PAPER SESSION: Mathematical Modeling Projects That Matter, Session 1				CONTRIBUTED PAPER S That Matter, Session 2	
<b>Elkhorn C (LC)</b>		GENERAL CONTRIBUTED PAPER SESSION #1: History and Philosophy				CONTRIBUTED PAPER S Trends in Undergraduate Mathema	
<b>Elkhorn D (LC)</b>		GENERAL CONTRIBUTED PAPER SESSION #2: Teaching and Learning				CONTRIBUTED PAPER S	
<b>Thoroughbred 1 (LC)</b>						PANEL SESSION: Assessing Mathematics Courses for Students in Business, Education, Engineering and Nursing	
<b>Thoroughbred 2 (LC)</b>		MAA STUDENT PAPER SESSION #1					MAA
<b>Thoroughbred 3 (LC)</b>		MAA STUDENT PAPER SESSION #2					MAA
<b>Thoroughbred 4 (LC)</b>						PANEL SESSION: Teaching Mathematics with the New Tablets: iPads, Slates and Smartphones	
<b>Thoroughbred 5 (LC)</b>		MAA STUDENT PAPER SESSION #3					MAA
<b>Thoroughbred 6 (LC)</b>		MAA STUDENT PAPER SESSION #4					
<b>Thoroughbred 7 (LC)</b>		MAA STUDENT PAPER SESSION #5					PI M SES
<b>Thoroughbred 8 (LC)</b>							PI M SES
<b>Berea Room (LC)</b>		GENERAL CONTRIBUTED PAPER SESSION #3: Applied Mathematics				GENERAL CONTRIBUTE	
<b>Patterson A (Hyatt)</b>							GRA SES
<b>Woodford/Scott Suite (Hyatt)</b>						MINICOURSE #2, PART 1 Traditional Grading to Enhance Str	
<b>Jessamine/Franklin Suite (Hyatt)</b>						MINICOURSE #1, PART 1 Approach to Differential Equation	
<b>Ballroom D (Hilton Hotel)</b>							
<b>Hyttops (Hyatt Hotel)</b>							

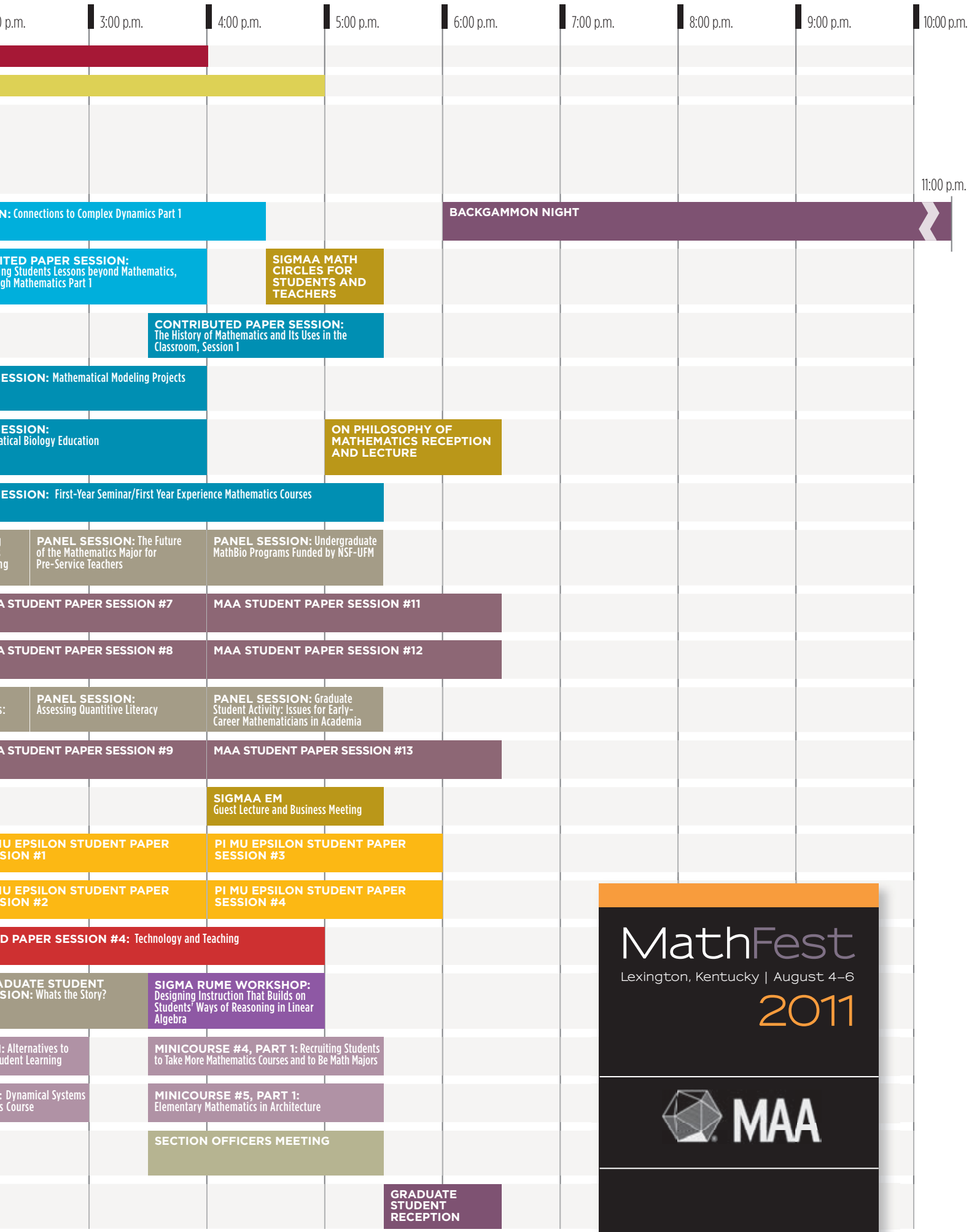

**MathFest**  
 Lexington, Kentucky | August 4-6  
**2011**

	8:00 a.m.	9:00 a.m.	10:00 a.m.	11:00 a.m.	12:00 p.m.	1:00 p.m.	2:00 p.m.
<b>Registration</b>	<b>REGISTRATION</b> (MathFast 2011 Registration is located in the Lexington Convention Center on Level 1)						
<b>Exhibit Hall</b>	<b>EXHIBIT HALL/STUDENT HOSPITALITY CENTER</b> (Located in the Heritage Ballroom East Level 1)					<b>CELEBRATING AWM STUDENT CHAPTERS POSTER SESSIONS</b>	
<b>Heritage Ballroom, Center</b>	<b>AWM-MAA MORNING COFFEE</b>	<b>AWM-MAA ETTA Z. FALCONER LECTURE:</b> Mathematical Interventions for Aneurysm Treatment by Dawn Lott	<b>EARLE RAYMOND HEDRICK LECTURE:</b> The Special Roles of Elliptic Curves by Manjul Bhargava	<b>JAMES R. LEITZEL LECTURE:</b> Just Walk Away, René: Cultural Issues in Broadening Participation in Mathematics by Philip Kutzko	<b>MAA PRIZE SESSION</b>		<b>NAM BLACKWELL LECTURE:</b> Using e-Mentoring to Prepare the Next Generation of Mathematics Teachers by Farrah Jackson Chandler
<b>Bluegrass Ballroom</b>							
<b>Heritage Ballroom 2 (LC)</b>							<b>INVITED PAPER SESSION</b>
<b>Heritage Ballroom 3 (LC)</b>							<b>UNDERGRADUATE STUDENT ACTIVITY:</b> Unshuffling for the Imperfect Mathemagician
<b>Elkhorn A (LC)</b>		<b>CONTRIBUTED PAPER SESSION:</b> Fostering, Supporting, and Propagating Math Circles for Students and Teachers, Session 2					<b>CONTRIBUTED PAPER SESSION:</b> What I Wish I Knew the First (or Second) Time I Taught Statistics
<b>Elkhorn B (LC)</b>		<b>CONTRIBUTED PAPER SESSION:</b> Geometry Topics That Engage Students, Session 1					<b>CONTRIBUTED PAPER SESSION:</b> Students, Session 2
<b>Elkhorn C (LC)</b>		<b>CONTRIBUTED PAPER SESSION:</b> Novel Ways to Incorporate Writing into Mathematics Classes, Session 1					<b>CONTRIBUTED PAPER SESSION:</b> Reasoning and Literacy: Pedagogical Approaches
<b>Elkhorn D (LC)</b>							<b>CONTRIBUTED PAPER SESSION:</b> Session 1
<b>Thoroughbred 1 (LC)</b>							<b>UNDERGRADUATE STUDENT SESSION:</b> Polynomia Pastimes
<b>Thoroughbred 2 (LC)</b>		<b>MAA STUDENT PAPER SESSION #15</b>					<b>MAA STUDENT PAPER SESSION #15</b>
<b>Thoroughbred 3 (LC)</b>		<b>MAA STUDENT PAPER SESSION #16</b>					<b>MAA STUDENT PAPER SESSION #16</b>
<b>Thoroughbred 4 (LC)</b>							<b>GRADUATE STUDENT ACTIVITY:</b> How to Write a Paper
<b>Thoroughbred 5 (LC)</b>		<b>MAA STUDENT PAPER SESSION #17</b>					<b>MAA STUDENT PAPER SESSION #17</b>
<b>Thoroughbred 6 (LC)</b>							
<b>Thoroughbred 7 (LC)</b>		<b>PI MU EPSILON STUDENT PAPER SESSION #5</b>					<b>PI MU EPSILON STUDENT PAPER SESSION #5</b>
<b>Thoroughbred 8 (LC)</b>		<b>PI MU EPSILON STUDENT PAPER SESSION #6</b>					<b>PI MU EPSILON STUDENT PAPER SESSION #6</b>
<b>Berea Room (LC)</b>		<b>GENERAL CONTRIBUTED PAPER SESSION #5:</b> Modeling and Applications					<b>GENERAL CONTRIBUTED PAPER SESSION #5:</b> Assessment, Mentoring & Outreach
<b>Patterson A (Hyatt)</b>							
<b>Woodford/Scott Suite (Hyatt)</b>							<b>MINICOURSE #2, PART 2:</b> Alternatives to Traditional Grading to Enhance Student Learning
<b>Jessamine/Franklin Suite (Hyatt)</b>							<b>MINICOURSE #1, PART 2:</b> A Dynamical Systems Approach to Equations Course

0 p.m.	3:00 p.m.	4:00 p.m.	5:00 p.m.	6:00 p.m.	7:00 p.m.	8:00 p.m.	9:00 p.m.	10:00 p.m.
REGISTRATION	EARLY-CAREER & GRADUATE STUDENTS POSTERFEST							
AWARDS SESSION						PI MU EPSILON J. SUTHERLAND FRAME LECTURE: You Can't Top This: Making Things Better with Mathematics by Margaret Wright		
				PI MU EPSILON BANQUET			ICE CREAM SOCIAL	
Connections to Complex Dynamics Part 2								
INVITED PAPER SESSION: Offering Students Lessons beyond Mathematics, through Mathematics Part 2			WEB SIGMAA: Mathematics Instruction Using the Web BUSINESS MEETING AND GUEST LECTURE					
SESSION: Second or $n^{\text{th}}$ Time								
SESSION: Geometry Topics That Engage								
SESSION: Quantitative Calcul Strategies								
SESSION: Recreational Mathematics: New Problems and New Solutions,								
INVITED PAPER SESSION: Polyhedra Are Everywhere!								
MAA STUDENT PAPER SESSION #19	MAA STUDENT PAPER SESSION #23							
MAA STUDENT PAPER SESSION #20	MAA STUDENT PAPER SESSION #24							
GRADUATE STUDENT ACTIVITY: How to Apply for a Job	PANEL SESSION: Summer Research Programs							
MAA STUDENT PAPER SESSION #21								
PI MU EPSILON STUDENT PAPER SESSION #7	PI MU EPSILON STUDENT PAPER SESSION #9							
PI MU EPSILON STUDENT PAPER SESSION #8	PI MU EPSILON STUDENT PAPER SESSION #10							
GENERAL CONTRIBUTED PAPER SESSION #6A:	GENERAL CONTRIBUTED PAPER SESSION #6B: Pure Mathematics I							
	SIGMAA RUME WORKSHOP: Designing Instruction that Builds on Student's Ways of Reasoning in Linear Algebra							
	MINICOURSE #6, PART 1: The Mathematics of Folding and Unfolding							
	MINICOURSE #3, PART 1: An In-Class Role-Playing Game for Quantitative Literacy: Social Security, 1935, Part 1							

# MathFest

Lexington, Kentucky | August 4-6

## 2011



	8:00 a.m.	9:00 a.m.	10:00 a.m.	11:00 a.m.	12:00 p.m.	1:00 p.m.	2:00 p.m.
<b>Registration</b>	<b>REGISTRATION</b> (MathFast 2011 Registration is located in the Lexington Convention Center on Level 1)						
<b>Exhibit Hall</b>	<b>EXHIBIT HALL/STUDENT HOSPITALITY CENTER</b> (Located in the Heritage Ballroom East Level 1)						
<b>Heritage Ballroom, Center</b>		<b>MAA INVITED ADDRESS:</b> Mathematical Approaches to Infectious Disease Prediction and Control by Lauren Ancel Meyers	<b>EARLE RAYMOND HEDRICK LECTURE:</b> How Many Points Are Needed on Average, to Generate all Rational Points on an Elliptic Curve? By Manjul Bharagava	<b>MAA INVITED ADDRESS:</b> In the Shadow of Desargues by Annalisa Crannell	<b>MAA BUSINESS MEETING</b>		
<b>Heritage Ballroom 2 (LC)</b>			<b>WORKSHOP:</b> Math Wrangle				<b>INVITED PAPER SESSION</b> to Perspective Art
<b>Heritage Ballroom 3 (LC)</b>							<b>INVITED PAPER SESSION</b> of Western Science: Implications
<b>Elkhorn A (LC)</b>		<b>CONTRIBUTED PAPER SESSION:</b> The History of Mathematics and Its Uses in the Classroom, Session 2					<b>GENERAL CONTRIBUTED</b> Pure Mathematics 3
<b>Elkhorn B (LC)</b>		<b>GENERAL CONTRIBUTED PAPER SESSIONS #7:</b> Pure Mathematics 2					<b>CONTRIBUTED PAPER S</b> Content Knowledge for Secondary
<b>Elkhorn C (LC)</b>		<b>CONTRIBUTED PAPER SESSION:</b> Novel Ways to Incorporate Writing into Mathematics Classes, Session 2					<b>CONTRIBUTED PAPER S</b> Novel Ways to Incorporate Writing
<b>Elkhorn D (LC)</b>		<b>CONTRIBUTED PAPER SESSION:</b> Recreational Mathematics: New Problems and New Solutions, Session 2					<b>CONTRIBUTED PAPER S</b> Teaching High School Mathematics Found on the Scenic Route
<b>Thoroughbred 1 (LC)</b>		<b>MAA MATHEMATICAL COMPETITION IN MODELING (MCM) WINNERS</b>					<b>MATH CIRCLES FOR STUDENTS AND TEACHERS</b>
<b>Thoroughbred 2 (LC)</b>							<b>GREAT TALKS FOR A GE</b> Coached Presentations by Gradua
<b>Thoroughbred 3 (LC)</b>							<b>STUDENT PROBLEM SOLVING COMPETITION</b>
<b>Thoroughbred 4 (LC)</b>							<b>PANEL SESSION:</b> Writing for MAA Journals and Magazines
<b>Thoroughbred 5 (LC)</b>							<b>GREAT TALKS FOR A GE</b> Coached Presentations by Gradua
<b>Thoroughbred Pre-Function Space (Level 3)</b>							
<b>Berea Room (LC)</b>		<b>GENERAL CONTRIBUTED PAPER SESSION #8:</b> Teaching Introductory Mathematics					<b>GENERAL CONTRIBUTED</b> Teaching Advanced Mathematics
<b>Woodford/Scott Suite (Hyatt)</b>							<b>MINICOURSE #4, PART 2</b> Recruiting Students to Take More Courses and to Be Math Majors
<b>Jessamine/Franklin Suite (Hyatt)</b>							<b>MINICOURSE #5, PART 2</b> Elementary Mathematics in Archi

12:00 p.m.	3:00 p.m.	4:00 p.m.	5:00 p.m.	6:00 p.m.	7:00 p.m.	8:00 p.m.	9:00 p.m.	10:00 p.m.
	SESSION: Projective Geometry Applied							
	SESSION: Cultural and Philosophic Underpinnings for American Mathematics in the 21st Century							
	GENERAL PAPER SESSION #9A:	GENERAL CONTRIBUTED PAPER SESSION #9B: Interdisciplinary Topics						
	SESSION: Know More, Teach Better? Teaching and Above							
	SESSION: Integrating into Mathematics Classes, Session 3			SIGMA TAHSM Business Meeting				
	SESSION: Beautiful Lessons							
	MATH CIRCLES FOR STUDENTS AND TEACHERS							
	GENERAL AUDIENCE: Intermediate Students							
		PANEL SESSION: Moving Up the Career Ladder in Academia						
	GENERAL AUDIENCE: Intermediate Students							
				SILVER AND GOLD BANQUET				
	GENERAL PAPER SESSION #10:							
	MINICOURSE #2: Mathematics	MINICOURSE #6, PART 2: The Mathematics of Folding and Unfolding						
	MINICOURSE #2: Lecture	MINICOURSE #3, PART 2: An In-Class Role-Playing Game for Quantitative Literacy: Social Security, 1935						

# MathFest

Lexington, Kentucky | August 4-6

## 2011



# Floor Plans

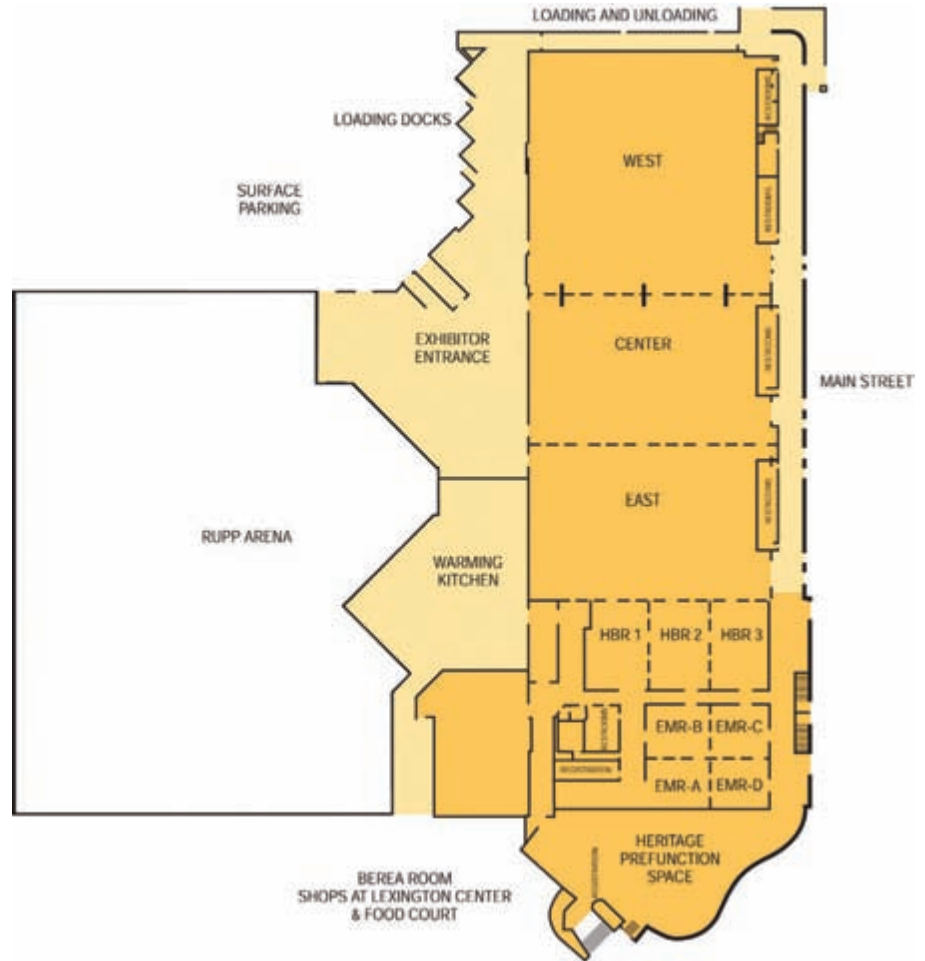



# W. H. FREEMAN AND COMPANY

*Solutions for Success*

For more on these and other titles visit Booth #38

## MATHEMATICS

FROM JON ROGAWSKI

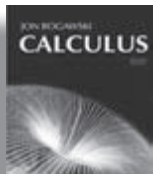

**CALCULUS,**  
Second Edition

**CALCULUS**  
Early Transcendentals,  
Second Edition

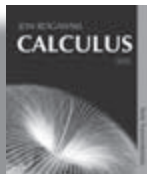

**ROGAWSKI ONLINE  
HOMEWORK OPTIONS  
STOP BY BOOTH #38  
FOR DEMOS**



### NEW FOR 2012



Coming  
January 2012

**FOR ALL PRACTICAL PURPOSES,**  
Ninth Edition  
COMAP, Inc.

**QUANTITATIVE  
LITERACY**

**Thinking Between the Lines**  
Bruce Crauder | Benny Evans |  
Jerry Johnson | Alan Noell



Coming  
January 2012

Available to accompany the above titles:



Coming  
January 2012

**VECTOR CALCULUS,**  
Sixth Edition

Jerrold E. Marsden |  
Anthony Tromba

**LINEAR ALGEBRA  
With Applications  
Preliminary Edition**

Jeffrey Holt



**W. H.  
FREEMAN**  
www.whfreeman.com

## STATISTICS



Coming  
January 2012

**THE BASIC PRACTICE  
OF STATISTICS, Sixth Edition**

David S. Moore | William I. Notz |  
Michael Fligner

**ESSENTIAL STATISTICS**

David S. Moore



**INTRODUCTION TO THE  
PRACTICE OF STATISTICS, Seventh Edition**

David S. Moore | George P. McCabe |  
Bruce Craig

**STATISTICS:**

**Concepts and Controversies,  
Seventh Edition**

David S. Moore | William I. Notz



Coming  
January 2012

**DISCOVERING STATISTICS,**  
Second Edition

Daniel T. Larose

**DISCOVERING STATISTICS:**

**Brief Version**

Daniel T. Larose



**INTRODUCTORY  
STATISTICS:**

**A Problem Solving Approach**

Stephen Kokoska

**THE PRACTICE OF  
STATISTICS IN THE  
LIFE SCIENCES,  
Second Edition**

Brigitte Baldi | David S. Moore



**THE PRACTICE OF  
STATISTICS FOR BUSINESS  
AND ECONOMICS, Third Edition**

David S. Moore | George P. McCabe |  
Layth Alwan | Bruce Craig |  
William M. Duckworth III

**TECHNOLOGY SOLUTIONS  
STOP BY BOOTH #38  
FOR DEMOS**

statsportal

STATISTICS  
VIDEO TOOL KIT

CRUNCH IT!

## Tuesday, August 2, 2011

9:00 a.m. - 5:00 p.m., Bluegrass Room Salon A, Hilton Hotel

### Short Course

#### Trends in Mathematical Biology

Organizers: Holly Gaff and Jennifer Gallovich

## Wednesday, August 3, 2011

8:00 a.m. - 7:00 p.m., Lexington Convention Center, Level 1

### Registration

9:00 a.m. - 5:00 p.m., Bluegrass Room Salon A, Hilton Hotel

### Short Course

#### Trends in Mathematical Biology

Organizers: Holly Gaff and Jennifer Gallovich

4:00 p.m. - 5:30 p.m., Thoroughbred 3, Convention Center, Level 3

### Judging High School Contests

Presenter: Ben Fusaro

4:30 p.m. - 5:30 p.m., Thoroughbred 4

### MAA-PME Student Reception

5:30 p.m. - 6:15 p.m., Thoroughbred 1, Convention Center, Level 3

### Math Jeopardy

Organizers: Robert Vallin and Mike Berry

6:00 p.m. - 7:30 p.m., Lexington Convention Center, Level 1

### Grand Opening and Reception

7:30 p.m. - 9:30 p.m., Grand Kentucky Ballroom, Hilton Hotel

### Opening Banquet

MAA: *à la Carte Musical!*

MC: Paul Zorn

## Thursday, August 4, 2011

8:00 a.m. - 4:00 p.m., Lexington Convention Center, Level 1

### Registration

8:30 a.m. - 9:20 a.m., Center Ballroom, Lexington Convention Center, Level 1

### AMS- MAA Joint Invited Address

#### Polynomial Dynamics: Conjugacy and Combinatorics

Laura DeMarco, University of Illinois at Chicago

8:30 a.m. - 10:15 a.m., Elkhorn C

### General Contributed Paper Session #1

#### History and Philosophy

Linda Becerra & Ron Barnes, University of Houston-Downtown

8:30 a.m. - 8:40 a.m.

#### Designing a New History of Mathematics Course

Julianna C. Stockton, Sacred Heart University

8:45 a.m. - 8:55 a.m.

#### A Mile Wide and an Inch Deep - 4000 BCE to 1950

Jeff Johannes, State University of New York, Geneseo

9:00 a.m. - 9:10 a.m.

#### History of Mathematics: An Exercise in Strengths

Mary B. Walkins, Lee University

9:15 a.m. - 9:25 a.m.

#### Key Contributors in the Evolving Role of Women in Mathematics

Linda Becerra, University of Houston-Downtown

9:30 a.m. - 9:40 a.m.

#### Ten Mathematicians Who Proclaimed the Greatness of God

Dale L. McIntyre, Grove City College

9:45 a.m. - 9:55 a.m.

#### The Mathematics of the Calendar

Doy Hollman, Lipscomb University

10:00 a.m. - 10:10 a.m.

#### Assessment Methods for Teaching the History of Mathematics Online

David Nacin, William Paterson University

8:30 a.m. - 10:15 a.m., Elkhorn D

### General Contributed Paper Session #2

#### Teaching and Learning

Lynette Boos, Providence College

8:30 a.m. - 8:40 a.m.

#### Bringing Neuroscience into the Mathematics Classroom

Alexander Atwood, Suffolk County Community College

8:45 a.m. - 8:55 a.m.

#### Empowering Students through Peer Mentoring in Early College Mathematics Courses

Kathryn A. Brennehan, North Carolina State University

9:00 a.m. - 9:10 a.m.

#### Examining How Teachers' Mathematics Content Knowledge Explains Teaching Practice

Elizabeth Burroughs, Montana State University

9:15 a.m. - 9:25 a.m.

#### Excursions to and from Semantic Oblivion

David Easdown, University of Sydney

9:30 a.m. - 9:40 a.m.

#### Mastery Learning: Meeting the Developmental Math Needs of a Variety of Students

Sue R. Beck, Morehead State University

9:45 a.m. - 9:55 a.m.

#### Understanding Classroom Voting

Holly Zullo, Carroll College

10:00 a.m. - 10:10 a.m.

#### Social Choice in a Liberal-Arts Mathematics Course

Gregory Kelsey, University of Illinois at Urbana-Champaign

Thursday, August 4, 2011 (continued)

8:30 a.m. - 10:25 a.m., Thoroughbred 2

**MAA Student Paper Session #1**

8:30 a.m. - 10:25 a.m., Thoroughbred 3

**MAA Student Paper Session #2**

8:30 a.m. - 10:25 a.m., Thoroughbred 5

**MAA Student Paper Session #3**

8:30 a.m. - 10:25 a.m., Thoroughbred 6

**MAA Student Paper Session #4**

8:30 a.m. - 10:25 a.m., Thoroughbred 7

**MAA Student Paper Session #5**

8:30 a.m. - 10:30 a.m., Elkhorn A

**Contributed Paper Session**

**Fostering, Supporting, and Propagating Math Circles for Students and Teachers**

Session 1

Organizers: *Tatiana Shubin, San Jose State University; and James Tanton, St. Mark's School*

8:30 a.m. - 8:45 a.m.

**The Beginnings of a Math Teachers' Circle**

*Debra Geddings, University of South Carolina  
Douglas Meade, University of South Carolina*

8:50 a.m. - 9:05 a.m.

**Math Circles Along the Hudson River:**

**From New York City to Albany**

*Japheth Wood, Bard College*

9:10 a.m. - 9:25 a.m.

**San Diego Math Circle: History, Structure, and Curriculum**

*David Patrick, Art of Problem Solving*

9:30 a.m. - 9:45 a.m.

**Math Teachers' Circles - A Descriptive Analysis of Final Evaluations from Summer Workshops**

*Diana White, University of Colorado, Denver*

9:50 a.m. - 10:05 a.m.

**AMS Epsilon: Funding for Summer Math Camps**

*Francis E. Su, Harvey Mudd College*

10:10 a.m. - 10:25 a.m.

**Always Be Prepared: Tips for Safe Outreach Programs**

*Brandy Wiegers, Mathematical Sciences Research Institute/San Francisco State University*

8:30 a.m. - 10:10 a.m., Elkhorn B

**Contributed Paper Session**

**Mathematical Modeling Projects That Matter**

Session 1

Organizers: *Mike Diehl, Endicott College; Matthew Pons, North Central College; and Katharine Ott, University of Kentucky*

8:30 a.m. - 8:45 a.m.

**Student Mathematical Modeling Projects**

**with Interactive Excel Spreadsheets**

*Christopher Thron, Texas A&M University, Central Texas*

8:50 a.m. - 9:05 a.m.

**Modeling Loan Payments with Algebra and Spreadsheets**

*Eileen Fernandez, Montclair State University*

9:10 a.m. - 9:25 a.m.

**Mathematical Modeling for Pre-Service Middle School Teachers**

*Jerry Dwyer, Texas Tech University*

9:30 a.m. - 9:45 a.m.

**Modeling Cooperative Systems**

*David Arney, United States Military Academy*

9:50 a.m. - 10:05 a.m.

**Student Multimedia Projects Connect the Real World to Model Visualization in Multivariable Calculus**

*Lee Gibson, University of Louisville*

8:30 a.m. - 10:30 a.m., Berea Room

**General Contributed Paper Session #3**

**Applied Mathematics**

*Helmut Knaust, University of Texas at El Paso*

8:30 a.m. - 8:40 a.m.

**Convergence of an Immersed Finite Element Method for Semilinear Parabolic Interface Problems**

*Champike Attanayake, Miami University, Middletown*

8:45 a.m. - 8:55 a.m.

**Decomposition of a Complete Graph into Paths with no Subsystems**

*Venkata C. Dinavahi, The University of Findlay*

9:00 a.m. - 9:10 a.m.

**Derivation of the Kinetic Component of the Gluon Four Momentum Operator**

*Kevin Murphy, St. Norbert College*

9:15 a.m. - 9:25 a.m.

**Idempotent Algebra Solutions for Some Minimax Location Problems**

*Nikolai Krivulin, St. Petersburg State University*

9:30 a.m. - 9:40 a.m.

**Identification Problems for Nonlinear Hyperbolic PDEs, with Boundary Data**

*Narayan Thapa, Minot State University*

9:45 a.m. - 9:55 a.m.

**On the Computation of Multiweighted Shapley Values**

*Irinel Dragan, University of Texas*

10:00 a.m. - 10:10 a.m.

**Quantum Chromo/Electro-Dynamic Matrix Algebra and Its Geometric Dual**

*Wayne R. Lundberg, United States Air Force*

10:15 a.m. - 10:25 a.m.

**Sparse Signal Recovery Using Large-Scale Optimization**

*Roummel Marcia, University of California, Merced*

9:00 a.m. - 5:00 p.m., Lexington Convention Center, Level 1

**Exhibits**

## Thursday, August 4, 2011 (continued)

9:00 a.m. - 5:00 p.m., Lexington Convention Center, Level 1

**Student Hospitality Center**

9:30 a.m. - 10:20 a.m., Heritage Ballroom, Lexington Convention Center, Level 1

**MAA Invited Address****Planting Your Roots in the Natural Numbers:****A Rational and Irrational Look at 1,2,3,4, ...***Edward Burger, Williams College*

10:30 a.m. - 11:20 a.m., Heritage Ballroom, Lexington Convention Center, Level 1

**Earle Raymond Hedrick Lecture****From Right-Angled Triangles to Algebraic Curves***Manjul Bhargava, Princeton University*

1:00 p.m. - 1:50 p.m., Heritage Ballroom, Lexington Convention Center, Level 1

**MAA Lecture for Students****Math Icons***Roger Nelsen, Lewis & Clark College*

1:00 p.m. - 2:20 p.m., Thoroughbred 1

**Panel Session****Assessing Mathematics Courses for Students in Business, Education, Engineering, and Nursing***Organizers: Bonnie Gold, Monmouth State University, and William Martin, North Dakota State University**Panelists: Bonnie Gold, Monmouth University; William O. Martin, North Dakota State University; Frank Raymond, Bellarmine University's W. Fielding Rubel School of Business; and Diane Orr Chlebowy, University of Louisville School of Nursing*

1:00 p.m. - 2:20 p.m., Thoroughbred 4

**Panel Session****Teaching Mathematics with the New Tablets: iPads, Slates, and Smartphones***Organizer: Lila Roberts, Clayton State University**Panelists: John Ehrke, Abilene Christian University; Doug Ensley, Shippensburg University; Barbara Kaskosz, University of Rhode Island; and Lila Roberts, Clayton State University*

1:00 p.m. - 2:40 p.m., Elkhorn C

**Contributed Paper Session****Trends in Undergraduate Mathematical Biology Education***Organizer: Timothy Comar, Benedictine University*

1:00 p.m. - 1:15 p.m.

**Preparing Students to Engage in Research Through a Biocalculus Course***Timothy D. Comar, Benedictine University*

1:20 p.m. - 1:35 p.m.

**An Undergraduate Algebra Curriculum Motivated by Recent Advances in Mathematical Biology***Rohan Attele, Chicago State University*

1:40 p.m. - 1:55 p.m.

**A Close-Knit Group at a Large Urban University - Long-Term Involvement in Undergraduate Research***Istvan Lauko, University of Wisconsin, Milwaukee*

2:00 p.m. - 2:15 p.m.

**Using Elementary Probability and Statistics to Understand the Florida Panther Population***Andrew Lazowski, Sacred Heart University*

2:20 p.m. - 2:35 p.m.

**Undergraduate Research Projects Focusing on the Comparison of Boolean and Continuous Dynamics of Gene Networks***Dan Hrozencik, Chicago State University*

1:00 p.m. - 3:00 p.m., Hyatt Hotel Woodford/Scott Suites

**Minicourse #2, Part 1****Alternatives to Traditional Grading to Enhance Student Learning***Presenters: Michael A. Brilleslyper and Beth Schaubroek, U.S. Air Force Academy*

1:00 p.m. - 3:00 p.m., Hyatt Hotel Jessamine/Franklin Suites

**Minicourse #1, Part 1****A Dynamical Systems Approach to the Differential Equations Course***Presenter: Paul Blanchard, Boston University*

1:00 p.m. - 4:30 p.m., Heritage 2

**Invited Paper Session****Connections to Complex Dynamics***Organizers: Rodrigo Perez and Roland Roeder, Indiana University-Purdue University, Indianapolis*

1:00 p.m. - 4:30 p.m.

**Complex Dynamics in Two Variables: An Example***Jeffrey Diller, University of Notre Dame*

1:45 p.m. - 2:15 p.m.

**Lee-Yang-Fisher Zeros and Rational Dynamics***Roland Roder, Indiana University-Purdue University, Indianapolis*

2:30 p.m. - 3:00 p.m.

**Rock-Paper-Scissors in the Complex World***Joshua Bowman, SUNY Stony Brook*

3:15 p.m. - 3:45 p.m.

**Three-Dimensional Monomial Maps***Jan-Li Lin, Indiana University*

4:00 p.m. - 4:30 p.m.

**Checkerboard Julia Sets***Paul Blanchard, Boston University*

1:00 p.m. - 4:00 p.m., Elkhorn B

**Contributed Paper Session****Mathematical Modeling Projects That Matter**

Session 2

*Organizers: Mike Diehl, Endicott College; Matthew Pons, North Central College; and Katharine Ott, University of Kentucky*

1:00 p.m. - 1:15 p.m.

**Surviving an Outbreak of Zombiism: Mathematical Modeling Meets Pop Culture***Robert Allen, University of Wisconsin, La Crosse*

Thursday, August 4, 2011 (continued)

1:20 p.m. - 1:35 p.m.

**Expandable Combinatorial Lottery Modeling Projects**  
*Melanie Pivarski, Roosevelt University*

1:40 p.m. - 1:55 p.m.

**From Modeling Projects to Original Research—An Undergraduate Course in Modeling**  
*Gabriella Pinter, University of Wisconsin, Milwaukee*

2:00 p.m. - 2:15 p.m.

**Modeling a Diving Board**  
*Michael A. Karls, Ball State University*

2:20 p.m. - 2:35 p.m.

**How Does the Size of Your Stomach Change During a Meal?**  
*Mark I. Nelson, University of Wollongong*

2:40 p.m. - 2:55 p.m.

**Modeling Water Flow from a Clepsydra in Calculus II**  
*Brian Hollenbeck, Emporia State University*

3:00 p.m. - 3:15 p.m.

**Interdisciplinary Connections: Applications of Differential Equations in Water Quality, Biomechanics, and Robotics**  
*Kimberly Kendricks, Central State University*

3:20 p.m. - 3:35 p.m.

**Sparse Matrix Solution in Muscle Contraction Modeling**  
*David Coulliette, Asbury University*

3:40 p.m. - 3:55 p.m.

**Thinking about Thinking: Projects with Neural Network Models**  
*Melvin Royer, Indiana Wesleyan University*

1:00 p.m. - 5:20 p.m., Elkhorn D

**Contributed Paper Session**  
**First-Year Seminar/First-Year Experience Mathematics Courses**

*Organizers: Jon L. Johnson, Elmhurst College; and Cheryl J. McAlister, Southeast Missouri State University*

1:00 p.m. - 1:15 p.m.

**A First-Year Seminar: What Is Mathematics and Why Won't It Go Away?**  
*Susan Jane Colley, Oberlin College*

1:20 p.m. - 1:35 p.m.

**Engaging Students in Mathematical Conversations: From Book Clubs to Freshmen Seminars**  
*Alessandra Pantano, University of California, Irvine*

1:40 p.m. - 1:55 p.m.

**Paul Erdos, Ramsey Theory, and the Question of Beauty in Mathematics**  
*Peter F. Blanchard, University of Iowa*

2:00 p.m. - 2:15 p.m.

**A Learning Community Partnering Pre-Calculus with Introduction to STEM Degrees and Careers**  
*Teri Murphy and Lisa Holden, Northern Kentucky University*

2:20 p.m. - 2:35 p.m.

**Calculating Truth, Beauty, Justice, and Fairness**  
*R. Duane Skaggs, Morehead State University*

2:40 p.m. - 2:55 p.m.

**Culture, Science, and Mathematics in the Pre-Columbian Americas**  
*Ximena Catepillan, Millersville University*

3:00 p.m. - 3:15 p.m.

**Great Mathematics Discoveries—Elucidated through Reading and Writing**  
*Agnes M. Rash, Saint Joseph's University*

3:20 p.m. - 3:35 p.m.

**Mathematics Courses in the Montserrat Program at the College of the Holy Cross**  
*John B. Little, College of the Holy Cross*

3:40 p.m. - 3:55 p.m.

**Two First-Year Seminar Course Designs for Science and Mathematics Majors**  
*Helmut Knaust, The University of Texas at El Paso*

4:00 p.m. - 4:15 p.m.

**Numbers and Native American Mathematics**  
*Jon L. Johnson, Elmhurst College*

4:20 p.m. - 4:35 p.m.

**Cryptology and Problem Solving with No Prerequisites**  
*Keith E. Mellinger, University of Mary Washington*

4:40 p.m. - 4:55 p.m.

**Wheels and Deals: An FYS on Television Game Shows**  
*Alison Marr, Southwestern University*

5:00 p.m. - 5:15 p.m.

**Extrapolating from a First-Year Experience for Mathematics Majors**  
*Jacqueline M. Dewar, Suzanne Larson, and Thomas Zachariah, Loyola Marymount University*

1:00 p.m. - 4:45 p.m., Berea Room

**General Contributed Paper Session #4**  
**Technology and Teaching**  
*Jose Giraldo, Texas A&M University-Corpus Christi*

1:00 p.m. - 1:10 p.m.

**3 Online Homework Systems for Statistics Service Courses**  
*Carol Vobach, University of Houston-Downtown*

1:15 p.m. - 1:25 p.m.

**Enhancing the Classroom Experience with Tablet PC Technology**  
*Megan Sawyer, North Carolina State University*

1:30 p.m. - 1:40 p.m.

**Experimental Mathematics and Data Mining: Extracting Identities from the Online Encyclopedia of Integer Sequences**  
*Hieu Nguyen, Rowan University*

1:45 p.m. - 1:55 p.m.

**A Flash Library for Ordinary Differential Equations**  
*Luiz Martins, Cleveland State University*

## Thursday, August 4, 2011 (continued)

2:00 p.m. - 2:10 p.m.

**Strategies for Using Computer Algebra Systems in Undergraduate Math Courses***Jerome Heaven, Indiana Tech*

2:15 p.m. - 2:25 p.m.

**Student Programming Projects to Create Pedagogically Effective Calculus Applets***Philip B. Yasskin, Texas A&M University*

2:30 p.m. - 2:40 p.m.

**The Microsoft Word Free Mathematics Add-In and Microsoft Mathematics Beta 4.0***Gail Nord, Gonzaga University*

2:45 p.m. - 2:55 p.m.

**Using Online Assessment Effectively in Large Courses***Lisa Townsley, University of Georgia*

3:00 p.m. - 3:10 p.m.

**Using Technology to Manage and Teach Developmental Online Mathematics Courses***Kendra Schroeder, Morehead State University*

3:15 p.m. - 3:25 p.m.

**Using Translations as a Tool to Broaden Effectiveness of Maplets for Calculus Applets***Douglas Meade, University of South Carolina*

3:30 p.m. - 3:40 p.m.

**A New Way to Teach Calculus - with Visualization, Technology, and Local Linearity***Jason Samuels, City University of New York*

3:45 p.m. - 3:55 p.m.

**Constructing Geometric Concepts with Real, Tangible Surfaces***Aaron Wangberg, Winona State University*

4:00 p.m. - 4:10 p.m.

**Homework Helpers in Multivariable Calculus***Susan Wildstrom, Walt Whitman High School*

4:15 p.m. - 4:25 p.m.

**Using M4C Maplets and Online Calculus at UALR***Denise LeGrand, University of Alabama, Little Rock*

4:30 p.m. - 4:40 p.m.

**WebWork Online Homework Problems with Embedded Flash Coming Soon to the National Problem Library***Barbara Margolius, Cleveland State University*

2:00 p.m. - 3:20 p.m., Patterson Ballroom A, Hyatt Hotel

**Graduate Student Workshop****What's the Story? A Graduate Student Workshop on Creating a Research Presentation for Undergraduates***Organizers: Aaron Luttman, Clarkson University; and Rachel Schwell, Central Connecticut State University*

2:00 p.m. - 3:55 p.m., Thoroughbred 2

**MAA Student Paper Session, #7**

2:00 p.m. - 3:55 p.m., Thoroughbred 3

**MAA Student Paper Session, #8**

2:00 p.m. - 3:55 p.m., Thoroughbred 5

**MAA Student Paper Session, #9**

2:00 p.m. - 3:55 p.m., Thoroughbred 7

**Pi Mu Epsilon Student Paper Session, #1**

2:00 p.m. - 3:55 p.m., Thoroughbred 8

**Pi Mu Epsilon Student Paper Session, #2**

2:00 p.m. - 4:00 p.m., Heritage 3

**Invited Paper Session****Offering Students Lessons Beyond Mathematics, through Mathematics***Edward Burger, Williams College*

2:00 p.m. - 2:20 p.m.

**Teaching Lessons That Last a Lifetime***Michael Starbird, The University of Texas at Austin*

2:30 p.m. - 2:50 p.m.

**An Entrepreneur's Appreciation of the Moore Method: How Lessons Learned from R. L. Moore's Classes Helped Me Succeed in Life and in Business***Harry Lucas Jr., The Educational Advancement Foundation*

3:00 p.m. - 3:20 p.m.

**Thinking, Writing, and Life-Long Learning***Deborah Bergstrand, Swarthmore College*

3:30 p.m. - 3:50 p.m.

**When Am I Ever Going to Use This? Developing the Life Skill of Thinking Mathematically***Lew Ludwig, Denison University*

2:35 p.m. - 3:55 p.m., Thoroughbred 4

**Panel Session****Assessing Quantitative Literacy***Organizer: Aaron Montgomery, Central Washington University**Panelists: Bernard Madison, University of Arkansas; Semra Kilic-Bahi, Colby-Sawyer College; and Donna Sundre, James Madison University*

2:35 p.m. - 3:55 p.m., Thoroughbred 1

**Panel Session****The Future of the Mathematics Major for Pre-Service Teachers***Organizers: Martha J. Siegel, Towson State University; and Kenneth C. Millett, University of California, Santa Barbara**Panelists: Elizabeth Burroughs, Montana State University; Bernard Madison, University of Arkansas; William McCallum, University of Arizona; and Dan Teague, North Carolina School of Mathematics and Science*

3:30 p.m. - 5:00 p.m., Kentucky Ballroom D, Hilton Hotel

**MAA Section Officers Meeting**

Thursday, August 4, 2011 (continued)

3:30 p.m. - 5:30 p.m., Elkhorn A

**Contributed Paper Session**

**The History of Mathematics and Its Uses in the Classroom, Session 1**

Organizers: Joel Haack, University of Northern Iowa; Pamela L. Peters, University of Wisconsin, Platteville; Pam Crawford, Jacksonville University; and Ximena P. Catepillan, Millersville University of Pennsylvania

3:30 p.m. - 3:45 p.m.

**An Early Approach to Finding Surfaces of Revolution**  
Andrew Leahy, Knox College

3:50 p.m. - 4:05 p.m.

**Infinity—Past, Present, and Possible**  
Thomas Drucker, University of Wisconsin, Whitewater

4:10 p.m. - 4:25 p.m.

**Modern Developments in Hilbert’s Program—and Problem 6**  
Wayne R. Lundberg, Physicist

4:30 p.m. - 4:45 p.m.

**Introducing Mathematical Philosophy in the Classroom**  
Nathan Moyer, Whitworth University

4:50 p.m. - 5:05 p.m.

**The Ball of Cork: Using History in Calculus, Abstract Algebra, and Dynamical Systems**  
Ezra Brown, Virginia Polytechnic Institute and State University

5:10 p.m. - 5:25 p.m.

**The Notion of Tree: Problems from the Past**  
Jerry Lodder, New Mexico State University

3:30 p.m. - 5:30 p.m., Hyatt Hotel Woodford/Scott Suites

**Minicourse #4, Part 1**

**Recruiting Students to Take More Mathematics Courses and to Be Math Majors**

Presenter: Michael Dorff, Brigham Young University

3:30 p.m. - 5:30 p.m., Hyatt Hotel Jessamine/Franklin Suites

**Minicourse #5, Part 1**

**Elementary Mathematics in Architecture**

Presenter: Alexander J. Hahn, University of Notre Dame

3:40 p.m. - 5:00 p.m., Patterson A Hyatt

**SIGMAA RUME Workshop**

**Designing Instruction That Builds on Students’ Ways of Reasoning in Linear Algebra**

**Environmental Mathematics**

4:00 p.m. - 4:45 p.m., Thoroughbred 6

**Guest Lecture**

4:45 p.m. - 5:30 p.m.

**Business Meeting**

4:00 p.m. - 6:15 p.m., Thoroughbred 2

**MAA Student Paper Session #11**

4:00 p.m. - 6:15 p.m., Thoroughbred 3

**MAA Student Paper Session #12**

4:00 p.m. - 6:15 p.m., Thoroughbred 5

**MAA Student Paper Session #13**

4:00 p.m. - 6:15 p.m., Thoroughbred 7

**Pi Mu Epsilon Student Paper Session #3**

4:00 p.m. - 6:15 p.m., Thoroughbred 8

**Pi Mu Epsilon Student Paper Session #4**

4:10 p.m. - 5:30 p.m., Thoroughbred 4

**Panel Session**

**Issues for Early-Career Mathematicians in Academia**

Organizer: Doug Ensley

Panelists: Ed Aboufadel, Grand Valley State University; Rebecca Garcia, Sam Houston State University; and Francis Su, Harvey Mudd College

4:10 p.m. - 5:30 p.m., Thoroughbred 1

**Panel Session**

**Undergraduate MathBio Programs Funded by NSF-UFM**

Organizer: Maeve McCarthy, Murray State University

Panelists: K. Renee Fister, Murray State University; Jay Walton, Texas A&M University; and Janet Best, Ohio State University

4:30 p.m. - 5:30 p.m., Heritage 3

**SIGMAA Math Circles for Students and Teachers Math Circles Demonstration**

5:00 p.m. - 5:30 p.m., Elkhorn C

**SIGMAA on Philosophy of Mathematics Reception**

5:30 p.m. - 6:30 p.m., Elkhorn C

**SIGMAA on Philosophy of Mathematics Guest Lecture:**

Neil Tennant, Department of Philosophy, Ohio State University

5:30 p.m. - 6:30 p.m., Hyttops, Hyatt Hotel, Lower Level A

**Graduate Student Reception**

Organizers: Estela A. Gavosto University of Kansas; and James Freeman, Cornell College

6:00 p.m. - 11:00 p.m., Heritage 2

**Backgammon Night**

Conducted by Art Benjamin

6:00 p.m. **Backgammon Practice**

7:00 p.m. **Backgammon Mathematics Quiz**

Hosted by Art Benjamin and Jennifer Quinn

8:00 p.m. **Backgammon Tournament**

## Friday August 5, 2011

8:00 a.m. - 4:00 p.m., Lexington Convention Center, Level 1

**Registration**

8:00 a.m. - 8:25 a.m., Center Ballroom, Convention Center, Level 1

**AWM-MAA Morning Coffee**

8:15 a.m. - 11:30 a.m., Berea Room

**General Contributed Paper Session #5  
Modeling and Applications***David Housman, Goshen College*

8:15 a.m. - 8:25 a.m.

**D-optimal Statistical Designs for MRI Experiments  
with Application to Nonlinear Models***Darcie Delzell, Wheaton College*

8:30 a.m. - 8:40 a.m.

**A Model for Psychiatric Patients Behaviors in  
Madonna University Teaching Hospital, Nigeria***Atabong T. Agendia, Madonna University, Nigeria*

8:45 a.m. - 8:55 a.m.

**A Quantitative Optimization Mathematical Model  
Analysis of Attributes Affecting Retention and  
Satisfaction Rates***Michael Miner, American Public University System*

9:00 a.m. - 9:10 a.m.

**A Special Quadratic Function Unifies Two  
Fundamental Quantities in Physics***Audey Shen, Henry M. Gunn High School*

9:15 a.m. - 9:25 a.m.

**Plane Geometry Modeling of Gravity Field Space  
Time Curves***Alexander L. Garron, Sand Box Geometry, LLC*

9:30 a.m. - 9:40 a.m.

**Applications of Matlab/CAS to Ecological Modeling***Leon Kaganovskiy, Touro College*

9:45 a.m. - 9:55 a.m.

**Mathematical Modeling of Obligate Mutualism  
Interactions: Leaf Cutter Ants and Fungus***Yun Kang, Arizona State University*

10:00 a.m. - 10:10 a.m.

**Mathematical Modeling with High-Speed Imagery***Michael C. Sostarecz, Monmouth College*

10:15 a.m. - 10:25 a.m.

**Queuing Model of Congested System Having  
Unknown Number of Servers, with Application  
to Highway Traffic***Mike Johnson, Meredith College*

10:30 a.m. - 10:40 a.m.

**Real World Applications of Mathematics***Darren Narayan, Rochester Institute of Technology;  
Joy Lind, University of Sioux Falls*

10:45 a.m. - 10:55 a.m.

**Settling Velocity and Sedimentation in Low Reynolds  
Number Fluid Systems***Terry Jo Leiterman, St. Norbert College*

11:00 a.m. - 11:10 a.m.

**Tweaking the NFL's Quarterback Passer Rating  
for Better Results***Paul von Dohlen, William Paterson University*

8:30 a.m. - 9:20 a.m., Heritage Ballroom, Lexington Convention Center, Level 1

**AWM-MAA Etta Z. Falconer Lecture****Mathematical Interventions for Aneurysm Treatment***Dawn Lott, Delaware State University*

8:30 a.m. - 10:30 a.m., Elkhorn A

**Contributed Paper Session****Fostering, Supporting, and Propagating Math Circles  
for Students and Teachers, Session 2***Organizers: Tatiana Shubin, San Jose State University;  
and James Tanton, St. Mark's School*

8:30 a.m. - 8:45 a.m.

**Central Nebraska Math Teachers' Circle and Sticky  
Note Mathematics***Pari Ford, University of Nebraska at Kearney*

8:50 a.m. - 9:05 a.m.

**Polynomial Interpolation (Newton)  
and Related Activities***Robert Sachs, George Mason University*

9:10 a.m. - 9:25 a.m.

**Geometric Combinatorics—a Treasure Trove  
of Math Circle Problems***Tatiana Shubin, San Jose State University*

9:30 a.m. - 9:45 a.m.

**Using Modified KenKen Puzzles in Math Circles***Harold Reiter, University of North Carolina, Charlotte*

9:50 a.m. - 10:05 a.m.

**Fibonacci Surprises***James Tanton, St. Mark's School*

10:10 a.m. - 10:25 a.m.

**Discussion**

8:30 a.m. - 10:30 a.m., Elkhorn B

**Contributed Paper Session****Geometry-Topics That Engage Students**

Session 1

*Organizer: Sarah Mabrouk, Framingham State University*

8:30 a.m. - 8:45 a.m.

**Engaging Explorations in Geometry using Excel***Deane E. Arganbright, Divine Word University  
(Papua New Guinea)*

8:50 a.m. - 9:05 a.m.

**Using GeoGebra to Improve Understanding  
of Proofs in Geometry***William Schellhorn, Simpson College*



Friday, August 5, 2011 (continued)

9:10 a.m. - 9:25 a.m.

**Voila! Proofs with Iteratively Inscribed Triangles**  
Christopher Thron, Texas A&M University, Central Texas

9:30 a.m. - 9:45 a.m.

**Proofs That Explain: An Example**  
Margaret L. Morrow, State University of New York, Plattsburgh

9:50 a.m. - 10:05 a.m.

**Visualizing Algebraic Surfaces**  
Ivona Grzegorzczak, California State University, Channel Islands

8:30 a.m. - 11:30 a.m., Elkhorn C

**Contributed Paper Session**  
**Novel Ways to Incorporate Writing into Mathematics Classes**

Session 1

Organizers: Ryan Stufflebeam, Transylvania University; and Martin Montgomery, Sam Houston State University

8:30 a.m. - 8:45 a.m.

**Assigning a Mathematical Book Review in a Capstone Course**  
Maritza Branker, Niagara University

8:50 a.m. - 9:05 a.m.

**Expository Papers: Windows into the World of Mathematics**  
Thomas Q. Sibley, St. John's University

9:10 a.m. - 9:25 a.m.

**Journals and Reading and Websites, Oh My!**  
Susan Wildstrom, Walt Whitman High School

9:30 a.m. - 9:45 a.m.

**Mathematics and Me: Reflections on Liberal Arts Mathematics**  
Sarah L. Mabrouk, Framingham State University

9:50 a.m. - 10:05 a.m.

**Personal, Expository, Critical, and Creative: Using Writing in Mathematics Courses**  
Benjamin J. Braun, University of Kentucky

10:10 a.m. - 10:25 a.m.

**Reflecting and Connecting through Journals and Essays**  
Chris Oehrlein, Oklahoma City Community College

10:30 a.m. - 10:45 a.m.

**Seeing the Unseen: A Metaphor for Mathematics**  
Mike Pinter, Belmont University

10:50 a.m. - 11:05 a.m.

**Truth and Beauty: A Course in Mathematics in Literature**  
Marion D. Cohen, Arcadia University

11:10 a.m. - 11:25 a.m.

**The Mathematics Correspondent**  
Linda McGuire, Muhlenberg College

8:30 a.m. - 11:45 a.m., Thoroughbred 2

**MAA Student Paper Session #15**

8:30 a.m. - 11:45 a.m., Thoroughbred 3

**MAA Student Paper Session #16**

8:30 a.m. - 11:45 a.m., Thoroughbred 5

**MAA Student Paper Session #17**

8:30 a.m. - 11:45 a.m., Thoroughbred 7

**Pi Mu Epsilon Student Paper Session #5**

8:30 a.m. - 11:45 a.m., Thoroughbred 8

**Pi Mu Epsilon Student Paper Session #6**

9:00 a.m. - 5:00 p.m., Lexington Convention Center, Level 1

**Exhibits**

9:00 a.m. - 5:00 p.m., Lexington Convention Center, Level 1

**Student Hospitality Center**

9:30 a.m. - 10:20 a.m., Heritage Ballroom, Lexington Convention Center, Level 1

**Earle Raymond Hedrick Lecture**

**The Special Role of Elliptic Curves**  
Manjul Bhargava, Princeton University

10:30 a.m. - 11:20 a.m., Heritage Ballroom, Lexington Convention Center, Level 1

**James R. Leitzel Lecture**

**Just Walk Away, René: Cultural Issues in Broadening Participation in Mathematics**  
Philip Kutzko, University of Iowa

11:30 a.m. - 12:00 p.m., Heritage Ballroom, Lexington Convention Center, Level 1

**MAA Prize Session**

1:00 p.m. - 1:50 p.m., Heritage Ballroom, Lexington Convention Center, Level 1

**NAM David Blackwell Lecture**

**Using e-Mentoring to Prepare the Next Generation of Mathematics Teachers**  
Farrah Jackson Chandler, Elizabeth City State University

1:00 p.m. - 1:50 p.m., Heritage Ballroom 3

**Undergraduate Student Activity**

**Unshuffling for the Imperfect Mathematician**  
Doug Ensley, Shippensburg University

1:00 p.m. - 1:50 p.m., Thoroughbred 1

**Undergraduate Student Activity**

**Polynomia Pasttimes**  
Dan Kalman, American University

1:00 p.m. - 2:30 p.m., Exhibit Hall, Lexington Convention Center

**Poster Session**

**Celebrating AWM Student Chapters**  
Organizer: Maia Averett, Mills College

## Friday, August 5, 2011 (continued)

1:00 p.m. - 3:00 p.m., Hyatt Hotel Jessamine/Franklin Suites

**Minicourse #1, Part 2****A Dynamical Systems Approach to the Differential Equations Course***Presenter: Paul Blanchard, Boston University*

1:00 p.m. - 3:00 p.m., Hyatt Hotel Woodford/Scott Suites

**Minicourse #2, Part 2****Alternatives to Traditional Grading to Enhance Student Learning***Presenters: Michael A. Brilleslyper and Beth Schaubroeck, U.S. Air Force Academy*

1:00 p.m. - 3:00 p.m., Elkhorn A

**Contributed Paper Session****What I Wish I Knew the First (or Second or... $n^{\text{th}}$ ) Time I Taught Statistics***Organizers: Brian Gill, Seattle Pacific University; Nancy Boynton, SUNY Fredonia; and Michael Posner, Villanova University*

1:00 p.m. - 1:15 p.m.

**Uncertain about Uncertainty: Motivating Statistical Thinking in Introductory Statistics Courses***Talithia Williams, Harvey Mudd College*

1:20 p.m. - 1:35 p.m.

**Statistical Concepts in Everyday Language***Richard Cleary, Bentley University*

1:40 p.m. - 1:55 p.m.

**Better Graphs, Better Formulas, and a Little Technology—Making Statistics a More Unified Course***Jason Samuels, City University of New York*

2:00 p.m. - 2:15 p.m.

**Technology in Basic Statistics Class***Annela Kelly, Roger Williams University*

2:20 p.m. - 2:35 p.m.

**Helping Business Students Acclimate to the Statistics Classroom***Susan D'Agostino, Southern New Hampshire University*

2:40 p.m. - 2:55 p.m.

**Let  $n = 1$ : The First Time Teaching Statistics***Jason Price, Nichols College*

1:00 p.m. - 4:30 p.m., Heritage 2

**Invited Paper Session****Connections to Complex Dynamics, Part 2***Organizers: Rodrigo Perez and Roland Roeder, Indiana University-Purdue University, Indianapolis*

1:00 p.m. - 1:30 p.m.

**The Period  $p$ -Curve for Cubic Polynomials***Araceli Bonifant, University of Rhode Island*

1:45 p.m. - 2:15 p.m.

**A Brief but Historic Article of Siegel***Rodrigo Perez, Indiana University-Purdue University, Indianapolis*

2:30 p.m. - 3:00 p.m.

**Julia Sets of Rational Maps Converging to Filled Julia Sets of Quadratic Polynomials***Bob Devaney, Boston University*

3:15 p.m. - 3:45 p.m.

**Wandering Vertices and Condensity in Julia Sets***Clinton Curry, SUNY Stony Brook*

4:00 p.m. - 4:30 p.m.

**Algorithms for Finding the Julia Sets of Hénon Maps***Phil Mummert, Taylor University*

1:00 p.m. - 3:20 p.m., Elkhorn C

**Contributed Paper Session****Quantitative Reasoning and Literacy: Pedagogical Strategies***Organizer: Mike LeVan, Transylvania University*

1:00 p.m. - 1:15 p.m.

**Keeping Quantitative Reasoning Courses Fresh and Relevant to Contemporary Society***Stuart Boersma, Central Washington University; Caren Diefenderfer, Hollins University; Bernard Madison, University of Arkansas*

1:20 p.m. - 1:35 p.m.

**Using Rubrics for Assessment, Guiding Student Thinking, and Designing Course Materials for Quantitative Reasoning***Stuart Boersma, Central Washington University; Caren Diefenderfer, Hollins University; Bernard Madison, University of Arkansas*

1:40 p.m. - 1:55 p.m.

**Common Sense: A Ten-Year Plan for Quantitative Literacy***Maura Mast, University of Massachusetts, Boston*

2:00 p.m. - 2:15 p.m.

**The State of Quantitative Literacy at Small Colleges and Universities***Jodie Miller, Mary Baldwin College*

2:20 p.m. - 2:35 p.m.

**Quantitative Reasoning Taught across the Curriculum***Martha Ellen Waggoner, Simpson College*

2:40 p.m. - 2:55 p.m.

**Service Learning in a Quantitative Reasoning Course***Allison Henrich, Seattle University*

3:00 p.m. - 3:15 p.m.

**Ladders Don't Slide***Ben Galluzzo, Shippensburg University*

1:00 p.m. - 3:30 p.m., Berea

**General Contributed Paper Session #6A: Assessment, Mentoring, & Outreach***Stephen Davis, Davidson College*

1:00 p.m. - 1:10 p.m.

**A 200-Question, Campus-Wide Math Contest***Brian Heinold, Mount St. Mary's University*

Friday, August 5, 2011 (continued)

1:15 p.m. - 1:25 p.m.

**A Model for Creating a Professional Development Program to Mentor Women Graduate Students**  
Jenna Carpenter, Louisiana Tech University

1:30 p.m. - 1:40 p.m.

**An In-House Placement Test: Challenges and Solutions**  
Elizabeth Mathai, Norwich University

1:45 p.m. - 1:55 p.m.

**AP Calculus: Concepts, Computation, and Communication**  
Tara L. Smith, University of Cincinnati

2:00 p.m. - 2:10 p.m.

**AP Calculus: Facts, Figures, and FAQs**  
Stephen Kokoska, Bloomsburg University

2:15 p.m. - 2:25 p.m.

**Helping Teachers and Parents Increase Persistence of Minority Students, and All Students, in Mathematics**  
Senan Hayes, Western Connecticut State University

2:30 p.m. - 2:40 p.m.

**Identifying Crucial Concepts and Skills for Success in College Algebra through Calculus**  
Marc Harper, University of California, Los Angeles;  
Alison Ahlgren, University of Illinois

2:45 p.m. - 2:55 p.m.

**In-depth Look into National Research Experience for Undergraduates Programs (NREUP)**  
Gulden Karakok, University of Northern Colorado

3:00 p.m. - 3:10 p.m.

**Math Chats: Engaging Students in Mathematics Outside the Classroom**  
Robin L. Anderson, Southwestern Illinois College

3:15 p.m. - 3:25 p.m.

**Women Count, Everyone Counts**  
Elizabeth Yanik, Emporia State University

1:00 p.m. - 4:00 p.m., Elkhorn D

**Contributed Paper Session**

**Geometry-Topics That Engage Students, Session 2**  
Organizer: Sarah Mabrouk, Framingham State University

1:00 p.m. - 1:15 p.m.

**A Geometry Based Math/Art Course with a Studio Component**  
Judith Silver and Jonathan Cox, Marshall University

1:20 p.m. - 1:35 p.m.

**Geometry in a Historical Frame**  
Ockle Johnson, Keene State College

1:40 p.m. - 1:55 p.m.

**Analyzing Floor Plans: A Geometry Lab**  
Emma Smith Zbarsky, Wentworth Institute of Technology

2:00 p.m. - 2:15 p.m.

**Symmetry and Shape: Geometry for Nonmajors**  
Penelope Dunham, Muhlenberg College

2:20 p.m. - 2:35 p.m.

**Geometry via Modeling**  
Marian Anton, Centre College

2:40 p.m. - 2:55 p.m.

**Using Arts and Crafts to Reinforce Geometric Concepts**  
Kristen Sellke, St. Mary's University of Minnesota

3:00 p.m. - 3:15 p.m.

**Using Paper Folding to Explore Euclidean Geometry**  
Carroll G. Wells, Lipscomb University

3:20 p.m. - 3:35 p.m.

**Kinesthetically Experiencing Geometry**  
Todd D. Oberg, Illinois College

3:40 p.m. - 3:55 p.m.

**All Hands on Deck: In Praise of Toys**  
Thomas Q. Sibley, St. John's University

1:00 p.m. - 4:40 p.m., Elkhorn D

**Contributed Paper Session**

**Recreational Mathematics: New Problems and New Solutions, Session 1**  
Organizers: Paul Coe and Kristen Schemmerhorn, Dominican University

1:00 p.m. - 1:15 p.m.

**Utility Theory and Deal or No Deal**  
Michael A. Jones, Mathematical Reviews

1:20 p.m. - 1:35 p.m.

**Come on Down! Mathematics Behind & e Price Is Right**  
Anthony DeLegge, Benedictine University

1:40 p.m. - 1:55 p.m.

**Wicked: A Problem in Counting and Probability**  
David Strong, Pepperdine University

2:00 p.m. - 2:15 p.m.

**Probability and Strategy in Farkle**  
Jeff Johannes, State University of New York, Geneseo

2:20 p.m. - 2:35 p.m.

**Words Searched: The Math of BOGGLE Logic Puzzles**  
Jonathan Needleman, Le Moyne College

2:40 p.m. - 2:55 p.m.

**Diagonal Tricks for KenKen Puzzles**  
Robert Vallin, Slippery Rock University

3:00 p.m. - 3:15 p.m.

**Pro Prob. Problem: Expected Number of Wins vs. Expectation of Winning Two-in-a-Row**  
Andrew Martin, Kentucky State University

3:20 p.m. - 3:35 p.m.

**The Ben-Hur Staircase Climb**  
Andrew Simoson, King College

## Friday, August 5, 2011 (continued)

3:40 p.m. - 3:55 p.m.

**Tracking Fugitives in the Hotel Yao: Organizational Schemes for Efficient Lookup***David J. Wildstrom, University of Louisville*

4:00 p.m. - 4:15 p.m.

**Think-Tac-Toe: When Are Puzzles Solvable?***Susa Stonedahl, Northwestern University;  
Forrest Stonedahl, Northwestern University*

4:20 p.m. - 4:35 p.m.

**Minimal Modified Slitherlink Puzzles***Hollie L. Buchanan, West Liberty University*

2:00 p.m. - 3:20 p.m., Thoroughbred 4

**Panel Session****How to Apply for a Job***Organizer: Estela A. Gavosto, University of Kansas**Panelists: Kim Roth, Juniata College; James Freeman, Cornell College; Estela Gavosto, University of Kansas; a faculty member from a community college to be determined; and a representative from the industry to be determined*

2:00 p.m. - 3:55 p.m., Thoroughbred 2

**MAA Student Paper Session #19**

2:00 p.m. - 3:55 p.m., Thoroughbred 3

**MAA Student Paper Session #20**

2:00 p.m. - 3:55 p.m., Thoroughbred 5

**MAA Student Paper Session #21**

2:00 p.m. - 3:55 p.m., Thoroughbred 7

**Pi Mu Epsilon Student Paper Session #7**

2:00 p.m. - 3:55 p.m., Thoroughbred 8

**Pi Mu Epsilon Student Paper Session #8**

2:00 p.m. - 5:00 p.m., Thoroughbred 1

**Invited Paper Session****Polyhedra Are Everywhere!***Organizer: Benjamin Braun*

2:00 p.m. - 2:20 p.m.

**Polyhedra in Number Theory: Integer Partitions from a Geometric Viewpoint***Matthias Beck, San Francisco State University*

2:30 p.m. - 2:50 p.m.

**Polyhedra in Optimization: Why Calculus Methods Fail to Really Integrate over a Polyhedron and How to Actually Do It!***Jesus De Loera, University of California, Davis*

3:00 p.m. - 3:20 p.m.

**Polyhedra in Math Education***Carl Lee, University of Kentucky*

3:30 p.m. - 3:50 p.m.

**Polyhedra in Geometric Combinatorics: The Characteristic Polynomial Strikes Again**  
*Caroline Klivans, The University of Chicago*

4:00 p.m. - 4:20 p.m.

**Polyhedra in Compressed Sensing***Jeffrey Blanchard, Grinnell College and University of Edinburgh*

4:30 p.m. - 4:50 p.m.

**Polyhedra in Algebraic Combinatorics: An Eulerian Relation for the Semisuspension***Margaret Readdy, University of Kentucky and the Institute for Advanced Study*

2:00 p.m. - 3:20 p.m., Heritage Ballroom, Lexington Convention Center, Level 1

**Alder Awards Session****Count Me In!***Alissa S. Crans***Lessons Learned in Year One of Calculus Coordination***Sarah Eichhorn***Greater Than the Sum of Its Parts***Sam Vandervelde*

2:30 p.m. - 4:00 p.m., Heritage 3

**Invited Paper Session****Offering Students Lessons Beyond Mathematics, through Mathematics***Organizer: Edward Burger, Williams College*

2:30 p.m. - 2:50 p.m.

**Changing Instructor Perception of Mathematics and Its Role in the Intellectual Development of Liberal Arts Students***Christina Carter, Buffalo State College*

3:00 p.m. - 3:20 p.m.

**Where's the Magic?***"Card" Colm: Mulcahy, Spelman College*

3:30 p.m. - 3:50 p.m.

**The Nature of Mathematics: Projects from Inspired Students***Candice H. Dance, Onondaga Community College (SUNY)*

3:30 p.m. - 5:00 p.m., Berea Room

**General Contributed Paper Session #6B****Pure Mathematics 1***Stephen Davis, Davidson College*

3:30 p.m. - 3:40 p.m.

**Three Irrational Rabbits and Meditating Transcendentals***Charlie Smith, Park University*

3:45 p.m. - 3:55 p.m.

**Investigations of the Riemann Hypothesis***Donald L. Hitzl, Stanford University, Retired*

Friday, August 5, 2011 (continued)

4:00 p.m. - 4:10 p.m.

**Riemann Zeta Function and Integral Representations of Apéry's Constant**

*Tilak de Alwis, Southeastern Louisiana University*

4:15 p.m. - 4:25 p.m.

**Variations on Euclid [ $n$ ], the Product of the First  $n$  Primes Plus One**

*Jay L. Schiffman, Rowan University*

4:30 p.m. - 4:40 p.m.

**Galois Group Computations via Resolvents and Subfields**

*Chad Awtrey, Elon University*

4:45 p.m. - 4:55 p.m.

**Asymptotic Regions in Snell Geometries**

*Jack Mealy, Austin College*

3:30 p.m. - 5:00 p.m., Exhibit Hall, Lexington Convention Center

**Poster Session**

**Early-Career and Graduate Students PosterFest**

*Organizers: Ed Aboufadel, Grand Valley State University; Aaron Luttmann, Clarkson University; and Bryant Mathews, Azusa Pacific University*

3:30 p.m. - 5:30 p.m., Hyatt Hotel Jessamine/Franklin Suites

**Minicourse #3, Part 1**

**An In-Class Role-Playing Game for Quantitative Literacy: Social Security, 1935**

*Presenters: John Curran and Andrew M. Ross, Eastern Michigan University*

3:30 p.m. - 5:30 p.m., Hyatt Hotel Woodford/Scott Suites

**Minicourse #6, Part 1**

**The Mathematics of Folding and Unfolding**

*Presenter: Joseph O'Rourke, Smith College*

3:40 p.m. - 5:00 p.m., Thoroughbred 4

**Panel Session**

**Summer Research Programs**

*Organizers: William Hawkins Jr., MAA and University of the District of Columbia; and Robert Megginson, University of Michigan*

*Panelists: Anthony Tongen, James Madison University; and Dawit Haile, Virginia State University*

3:40 p.m. - 5:00 p.m., Patterson Ballroom A, Hyatt Hotel

**SIGMAA Rume Workshop**

**Designing Instruction That Builds on Students' Ways of Reasoning in Linear Algebra**

4:00 p.m. - 6:15 p.m., Thoroughbred 3

**MAA Student Paper Session #24**

4:00 p.m. - 6:15 p.m., Thoroughbred 5

**MAA Student Paper Session #25**

4:00 p.m. - 6:15 p.m., Thoroughbred 7

**Pi Mu Epsilon Student Papers #9**

4:00 p.m. - 6:15 p.m., Thoroughbred 8

**Pi Mu Epsilon Student Papers #10**

5:00 p.m. - 6:30 p.m., Heritage 3

**Web SIGMAA**

**Mathematics Instruction Using the Web**

**Business Meeting and Reception**

*Speaker: Andrew Bennett, Kansas State University*

**Touchable Math with HTML5**

6:00 p.m. - 7:45 p.m., Bluegrass Ballroom

**Pi Mu Epsilon Student Banquet and Awards Ceremony**

8:00 p.m. - 8:50 p.m., Heritage Ballroom, Lexington Convention Center

**Pi Mu Epsilon J. Sutherland Frame Lecture**

**You Can't Top This: Making Things Better with Mathematics**

*Margaret Wright, Courant Institute of Mathematical Sciences*

9:00 p.m. - 10:00 p.m., Bluegrass Ballroom

**MAA Ice Cream Social**

## Saturday, August 6, 2011

8:00 a.m. - 2:00 p.m., Lexington Convention Center, Level 1

**Registration**

8:30 a.m. - 9:20 a.m., Heritage Ballroom, Lexington Convention Center, Level 1

**MAA Invited Address****Mathematical Approaches to Infectious Disease Prediction and Control***Lauren Ancel Meyers, University of Texas at Austin*

8:30 a.m. - 11:30 a.m., Elkhorn A

**Contributed Paper Session****The History of Mathematics and Its Uses in the Classroom, Session 2***Organizers: Joel Haack, University of Northern Iowa; Pamela L. Peters, University of Wisconsin at Platteville; Pam Crawford, Jacksonville University; Ximena P. Catepillan, Millersville University of Pennsylvania*

8:30 a.m. - 8:45 a.m.

**A Look at Five Interesting Triangles: Pascal, Chinese, Harmonic, Euler, and Prime***Jim Fulmer and Thomas McMillan, University of Arkansas at Little Rock*

8:50 a.m. - 9:05 a.m.

**Pedagogical Methods of Ancient Chinese Mathematics***Lisa D. Elliott, Austin Peay State University*

9:10 a.m. - 9:25 a.m.

**Bringing Historical Context to First-Year Mathematics Courses***Wojciech K. Kosek, Colorado Technical University*

9:30 a.m. - 9:45 a.m.

**Bringing Students into the Fold: Engagement through Mathematics History***Brian J. Lunday, United States Military Academy*

9:50 a.m. - 10:05 a.m.

**Cardano: A Minus Times a Minus Is Minus!?***Daniel J. Curtin, Northern Kentucky University*

10:10 a.m. - 10:25 a.m.

**Negative Numbers in School Mathematics***Patricia Baggett, New Mexico State University  
Andrzej Ehrenfeucht, University of Colorado*

10:30 a.m. - 10:45 a.m.

**Historical Quotes in Finding the Meaning and Language of Limits***Barbara Shipman, University of Texas at Arlington*

10:50 a.m. - 11:05 a.m.

**Mathematics and the Arts: A Historical Perspective***Amy Osborne-Wheeler, Art Institute of Ohio*

11:10 a.m. - 11:25 a.m.

**Quadratures of Parabolas: Integrating Before Newton***Troy Goodsell, Brigham Young University-Idaho*

8:30 a.m. - 11:30 a.m., Elkhorn C

**Contributed Paper Session****Novel Ways to Incorporate Writing Into Mathematics Classes, Session 2***Organizers: Ryan Stufflebeam, Transylvania University; and Martin Montgomery, Sam Houston State University*

8:30 a.m. - 8:45 a.m.

**Do the Students Really Understand What They're Doing?***Jason Moliterno, Sacred Heart University*

8:50 a.m. - 9:05 a.m.

**Curriculum Crossroads: Where the Writer Meets the Mode***Irina A. Chernikova, Michael Johanyak, and Sheldon Wrice, The University of Akron*

9:10 a.m. - 9:25 a.m.

**Incorporating Writing into an Introductory Statistics Course Focused on Sports and Games***Joe DeMaio and Amy DeMaio, Kennesaw State University*

9:30 a.m. - 9:45 a.m.

**Instruction in Mathematical Communication through Problem-Solving Explanations***Dan Schultz-Ela, Mesa State College*

9:50 a.m. - 10:05 a.m.

**Laboratory-Based Writing Activities in an Engineering Statistics Course***Joshua Holden, Rose-Hulman Institute of Technology*

10:10 a.m. - 10:25 a.m.

**Statistics in the World Around Us***Eric Ruggieri, Duquesne University*

10:30 a.m. - 10:45 a.m.

**Teaching Minitab by Student Memo Writing***Jacqueline Jensen, Sam Houston State University*

10:50 a.m. - 11:05 a.m.

**Using the *New York Times* in Statistics Class***Lanee Young, Fort Hays State University*

11:10 a.m. - 11:25 a.m.

**Writing Math from Intro Stat to Capstone***Therese Shelton, Southwestern University*

8:30 a.m. - 10:30 a.m., Elkhorn B

**General Contributed Paper Session #7  
Pure Mathematics 2***Adam Coffman, Indiana University-Purdue University, Fort Wayne*

8:30 a.m. - 8:40 a.m.

**A Sequence Related to the Stern Sequence***Melissa Dennison, Baldwin-Wallace College*

8:45 a.m. - 8:55 a.m.

**Another Way to Obtain the Sheffer Type-0 Orthogonal Polynomial Sequences***Daniel J. Galiffa, Penn State Erie, The Behrend College*

Saturday, August 6, 2011 (continued)

9:00 a.m. - 9:10 a.m.

**Correct and Simple Proof That “Product of Even Transpositions Is Not Product of Odd Transpositions”**  
*Peter Joyce, Community College of Baltimore County, Catonsville*

9:15 a.m. - 9:25 a.m.

**Equivalence of Discrete Morse Functions on Graphs**  
*Nick Scoville, Ursinus College*

9:30 a.m. - 9:40 a.m.

**Frame Extensions**  
*Papiya Bhattacharjee, Pennsylvania State University, Erie*

9:45 a.m. - 9:55 a.m.

**On a Golden Pair of Identities in the Theory of Numbers**  
*Robert P. Schneider, University of Kentucky*

10:00 a.m. - 10:10 a.m.

**On Numbers That Can Be Expressed as the Sum of Two Positive Squares in Exactly  $n$  Distinct Ways**  
*Jonathan Weisbrod, Rowan University*

10:15 a.m. - 10:25 a.m.

**Mobius Transformations and Ellipses**  
*Adam Coffman, Indiana University-Purdue University, Fort Wayne*

8:30 a.m. - 10:00 a.m., Berea Room

**General Contributed Paper Session #8**

**Teaching Introductory Mathematics**  
*Jose Giraldo, Texas A&M University-Corpus Christi*

8:30 a.m. - 8:40 a.m.

**College Algebra: Redesigned with Technology**  
*Chris Schroeder, Morehead State University*

8:45 a.m. - 8:55 a.m.

**Engaging Students Using Instant Feedback Assessment ... Is it Better Than Winning the Lottery?**  
*Susan Foege, Kentucky State University*

9:00 a.m. - 9:10 a.m.

**Introductory Problem-Solving Skills: An Alternative to Intermediate Algebra for Liberal Arts Majors**  
*Jeffery D. Sykes, Ouachita Baptist University*

9:15 a.m. - 9:25 a.m.

**Mandatory Supplemental Instruction in Precalculus Courses**  
*Gabriela Schwab, Emil Daniel Schwar, and Helmut Knaust, The University of Texas at El Paso*

9:30 a.m. - 9:40 a.m.

**Math Courses in the Science First-Year Learning Community at TAMUCC**  
*Jose Giraldo, Texas A&M University, Corpus Christi*

9:45 a.m. - 9:55 a.m.

**Introducing Joint and Conditional Probability in an Introductory Business Statistics Course**  
*Deborah J. Gougeon, University of Scranton*

8:30 a.m. - 11:30 a.m., Elkhorn D

**Contributed Paper Session**  
**Recreational Mathematics: New Problems and New Solutions**  
 Session 2

*Organizers: Paul Coe and Kristen Schemmerhorn, Dominican University*

8:30 a.m. - 8:45 a.m.

**Centrosymmetric Solutions to the  $N+k$  Queens Problem**  
*Richard D. Chatham, Morehead State University*

8:50 a.m. - 9:05 a.m.

**The Proof Is in the Pizza**  
*Greg N. Frederickson, Purdue University*

9:10 a.m. - 9:25 a.m.

**When Two Worlds Collide**  
*Pam Warton, The University of Findlay*

9:30 a.m. - 9:45 a.m.

**Fun Puzzles Using Modular Arithmetic**  
*Shenglan Yuan, LaGuardia Community College, City University of New York*

9:50 a.m. - 10:05 a.m.

**Juggling Sequences and Restrictions**  
*Jonathan Stadler, Capital University*

10:10 a.m. - 10:25 a.m.

**From Doodles to Induction: Recreational Research in Office Hours**  
*Patrick Rault, State University of New York, Geneseo*

10:30 a.m. 10:45 a.m.

**Describing all Gibonacci Sequences, Modulo  $m$**   
*Marc Renault, Shippensburg University*

10:50 a.m. - 11:05 a.m.

**Exploring the Home Prime Conjecture in Bases Duodecimal and Hexadecimal**  
*Jay L. Schiffman, Rowan University*

11:10 a.m. - 11:25 a.m.

**Weighted Magic Squares**  
*Hossein Behforooz, Utica College*

9:00 a.m. - 10:30 a.m., Thoroughbred 1

**Undergraduate Student Activity**  
**MAA Mathematical Competition in Modeling (MCM) Winners**

*Organizer: Ben Fusaro, Florida State University*

9:00 a.m. - 2:00 p.m., Lexington Convention Center, Level 1

**Exhibits**

9:00 a.m. - 2:00 p.m., Lexington Convention Center, Level 1

**Student Hospitality Center**

## Saturday, August 6, 2011 (continued)

9:30 a.m. - 10:20 a.m., Heritage Ballroom, Lexington Convention Center, Level 1

**Earle Raymond Hedrick Lecture**  
**How Many Points Are Needed on Average,  
 to Generate all Rational Points on an Elliptic Curve?**  
*Manjul Bhargava, Princeton University*

10:00 a.m., Heritage 2

**Workshop**  
**Math Wrangle**

10:30 a.m. - 11:20 a.m., Heritage Ballroom, Lexington Convention Center, Level 1

**MAA Invited Address**  
**In the Shadow of Desargues**  
*Annalisa Crannell, Franklin & Marshall College*

11:30 a.m. - 11:50 a.m., Heritage Ballroom, Lexington Convention Center, Level 1

**MAA Business Meeting**

1:00 p.m. - 2:00 p.m., Thoroughbred 1

**Math Circles for Students and Teachers**  
**Math Circles Demonstrations**

1:00 p.m. - 2:15 p.m., Thoroughbred 3

**Student Problem-Solving Competition**  
*Organizer: Richard Neal, American Society  
 for the Communication of Mathematics*

1:00 p.m. - 2:20 p.m., Thoroughbred 4

**Panel Session**  
**Writing for MAA Journals and Magazines**  
*Organizers: Ivars Peterson, Director of Publications  
 and Communications, MAA; and Walter Stromquist,  
 Editor, Mathematics Magazine*  
*Panelists: Scott Chapman, American Mathematical  
 Monthly, (Sam Houston State University); Michael Henle,  
 College Mathematics Journal, (Oberlin College); Tom  
 Leathrum, Loci, (Jacksonville State University); Walter  
 Stromquist, Mathematics Magazine; and Bruce Torrence,  
 Math Horizons (Randolph Macon College)*

1:00 p.m. - 3:00 p.m., Hyatt Hotel Woodford/Scott Suites

**Minicourse #4, Part 2**  
**Recruiting Students to Take More Mathematics  
 Courses and to Be Math Majors**  
*Presenter: Michael Dorff, Brigham Young University*

1:00 p.m. - 3:00 p.m., Hyatt Hotel Jessamine/Franklin Suites

**Minicourse #5, Part 2**  
**Elementary Mathematics in Architecture**  
*Presenter: Alexander J. Hahn, University of Notre Dame*

1:00 p.m. - 4:00 p.m., Heritage 2

**Invited Paper Session**  
**Projective Geometry Applied to Perspective Art**  
*Organizers: Annalisa Crannell, Franklin & Marshall College;  
 and Marc Frantz, Indiana University*

1:00 p.m. - 1:20 p.m.

**One-point, Two-point and Three-point Perspective  
 Drawings and How to View Them**  
*Don Row, University of Tasmania*

1:30 p.m. - 1:50 p.m.

**The Geometry of Visual Space**  
*Dick Termes, Artist*

2:00 p.m. - 2:20 p.m.

**Scene Analysis**  
*Talmadge James Reid, University of Mississippi*

2:30 p.m. - 2:50 p.m.

**Straightening Out Escher: Projective Geometry  
 as a Gateway to Visual Hyperbolic Geometry**  
*Norman J. Wildberger, University of New South Wales*

3:00 p.m. - 3:20 p.m.

**Modular Perspective vs. Traditional Methods**  
*Tomás García-Salgado, UNAM Mexico*

3:30 p.m. - 3:50 p.m.

**The Most Underrated Theorem in Projective  
 Geometry**  
*Marc Frantz, Indiana University*

1:00 p.m. - 4:00 p.m., Heritage 3

**Invited Paper Session**  
**Cultural and Philosophic Underpinnings of Western  
 Science: Implications for American Mathematics  
 in the 21st Century**  
*Organizer: Philip Kutzko, University of Iowa*

1:00 p.m. - 1:40 p.m.

**Cultural Issues in Transitioning to Graduate School  
 in Mathematics: A Personal Perspective**  
*Paulette Willis, University of Houston*

1:50 p.m. - 2:30 p.m.

**Cultural Aspects of Finding and Keeping Graduate  
 Students in the Mathematical Sciences**  
*David Manderscheid, University of Nebraska*

2:40 p.m. - 3:20 p.m.

**The Outsider's Challenge in Learning Science: Culture  
 and/or Orientation to Scientific Thinking and Practice**  
*Douglas Mupasiri, University of Northern Iowa*

3:30 p.m. - 4:10 p.m.

**Transforming Undergraduates into Researchers:  
 Best Practices from an Afrocentric Perspective**  
*Edray Herber Goins, Purdue University*

1:00 p.m. - 3:00 p.m., Elkhorn D

**Contributed Paper Session**  
**Teaching High School Mathematics: Beautiful Lessons  
 Found on the Scenic Route**  
*Organizer: Caren Diefenderfer, Hollins University*

1:00 p.m. - 1:15 p.m.

**Exploring Families of Curves**  
*Daniel J. Teague, North Carolina School of Science  
 and Mathematics*

1:20 p.m. - 1:35 p.m.

**Graphing Rational Functions and Solving Rational  
 Inequalities Without a Calculator**  
*Peter Joyce, Community College of Baltimore County,  
 Catonsville*



Saturday, August 6, 2011 (continued)

1:40 p.m. - 1:55 p.m.

**Outdoors with Mathematics in the National Parks**  
*Kristine Hoffman, West Platte R-II Jr./Sr. High School*

2:00 p.m. - 2:15 p.m.

**Proofs by Mathematical Induction for High School Students**

*Susan Wildstrom, Walt Whitman High School*

2:20 p.m. - 2:35 p.m.

**Size of  $n!$  (Stirling Approximation) in Calculus: Important, Useful, and Fun**

*Robert Sachs, George Mason University*

2:40 p.m. - 2:55 p.m.

**Using Explorations to Discover Derivatives**  
*Susan Wildstrom, Walt Whitman High School*

1:00 p.m. - 3:30 p.m., Elkhorn A

**General Contributed Paper Session #9A Pure Mathematics**

*David Housman, Goshen College*

1:00 p.m. - 1:10 p.m.

**A Brief Look at Graphs, Codes, and Schemes Obtained from Difference Sets**  
*John Polhill, Bloomsburg University of Pennsylvania*

1:15 p.m. - 1:25 p.m.

**Counting Knot Mosaics**  
*Rus May, Morehead State University*

1:30 p.m. - 1:40 p.m.

**Homological Generators and a Vanishing Conjecture**  
*Joshua Roberts, Piedmont College*

1:45 p.m. - 1:55 p.m.

**Inverting a Class of Vast Matrices Using Their Anti-Transposes**  
*Matt Hudelson, Washington State University*

2:00 p.m. - 2:10 p.m.

**On Infinite Subseries of the Harmonic Series**  
*Andrew Martin, Kentucky State University*

2:15 p.m. - 2:25 p.m.

**The Number of Complex Roots of a Univariate Polynomial Inside a Rectangle**  
*Jayantha L. Gan Hewage, University of Sri Jayewardenepura*

2:30 p.m. - 2:40 p.m.

**Existence of the Schubart Periodic Orbit with Arbitrary Masses**  
*Duokui Yan, Chern Institute of Mathematics*

2:45 p.m. - 2:55 p.m.

**Some Geometric Aspects of the Finite Element Method for Elliptic PDEs**  
*Benselamonyuy Ntatin, Austin Peay State University*

1:00 p.m. - 3:40 p.m., Elkhorn B

**Contributed Paper Session**

**Know More, Teach Better? Content Knowledge for Secondary Teaching and Above**

*Organizers: Cindy Traub, Vincent Kieftenbeld, and Adam Weyhaupt, Southern Illinois University, Edwardsville*

1:00 p.m. - 1:15 p.m.

**Number and Operation for Preservice Secondary Math Teachers**

*Diana White, University of Colorado, Denver*

1:20 p.m. - 1:35 p.m.

**Pre-college Mathematics from an Advanced Viewpoint**

*Elizabeth Bremigan, Ralph Bremigan, and John Lorch, Ball State University*

1:40 p.m. - 1:55 p.m.

**The Impact of K-12 Policy on 14-16+ Mathematics Education**

*Angela Bowzer, Westminster College  
Angela Hodge, North Dakota State University*

2:00 p.m. - 2:15 p.m.

**An Abstract Algebra Class for Secondary Mathematics Teachers**

*Justin Hill and Christopher Thron, Texas A&M University-Central Texas*

2:20 p.m. - 2:35 p.m.

**Capstone as a Transition**  
*Todd D. Oberg, Illinois College*

2:40 p.m. - 2:55 p.m.

**Blending Mathematical Content with Pedagogy in Upper-Level Mathematics Classes**  
*Joyati Debnath, Winona State University*

3:00 p.m. - 3:15 p.m.

**Increasing Prospective Secondary Teachers' Content and Pedagogical Knowledge through Problem Solving**  
*Jessica de la Cruz, Assumption College*

3:20 p.m. - 3:35 p.m.

**Teachers Analyzing Math in the Classroom: Using Video to Assess, Train, and Prepare Future Teachers**  
*Taliesin Sutton, University of Arizona*

1:00 p.m. - 4:00 p.m., Elkhorn C

**Contributed Paper Session**

**Novel Ways to Incorporate Writing into Mathematics Classes**

Session 3

*Organizers: Ryan Stufflebeam, Transylvania University; and Martin Montgomery, Sam Houston State University*

1:00 p.m. - 1:15 p.m.

**Combining Problem Solving and Writing in Single Variable Calculus Courses**

*Chad Awtrey, Elon University*

## Saturday, August 6, 2011 (continued)

1:20 p.m. - 1:35 p.m.

**Using Two Phased Writing Projects and Rough Draft Meetings for Calculus Writing Projects**  
Teena Carroll, St. Norbert College

1:40 p.m. - 1:55 p.m.

**Writing Projects for Calculus and Liberal Arts Mathematics**  
J. C. Tweddle, University of Evansville

2:00 p.m. - 2:15 p.m.

**Students Writing for One Another on Course Wikis**  
Jennifer D. Wagner, Washburn University

2:20 p.m. - 2:35 p.m.

**Using Wikis to Break the Language Barrier between Mathematics and Biology**  
Rebecca Vandiver, St. Olaf College

2:40 p.m. - 2:55 p.m.

**Wiki Technology Supports Inquiry**  
Brian Katz, Augustana University  
Elizabeth Katz, University of California, Santa Barbara

3:00 p.m. - 3:15 p.m.

**Using Writing to Reveal Students' Thinking and Learning**  
Katie S. Quertermous, James Madison University

3:20 p.m. - 3:35 p.m.

**What I Wish I Knew the First Time I Taught a Writing-Intensive Class**  
Yu-Ju Kuo, Indiana University of Pennsylvania

3:40 p.m. - 3:55 p.m.

**Using Writing to Motivate General Education Math Students**  
Eric Aurand, Kaplan University;  
Laurel Clifford, Mohave Community College

1:00 p.m. - 4:00 p.m., Berea Room

**General Contributed Paper Session #10 Teaching Advanced Mathematics**  
Lynette Boos, Providence College

1:00 p.m. - 1:10 p.m.

**Abel's Theorem Simplifies Reduction of Order**  
William R. Green, Eastern Illinois University

1:15 p.m. - 1:25 p.m.

**An Explore-First, Lecture-Later-and-Little Approach to Teaching Introduction to Differential Equations**  
Chris Oehrlein, Oklahoma City Community College

1:30 p.m. - 1:40 p.m.

**From Procedures to Proofs: Some Promising Ways for Undergraduates to Transition to Upper-Level Mathematics Courses**  
Kelly M. Bulp, Ohio University

1:45 p.m. - 1:55 p.m.

**Geometric Interpretations of Complex Variables and Complex-Valued Functions**  
Hortensia Soto-Johnson, University of Northern Colorado

2:00 p.m. - 2:10 p.m.

**Proof Journals**  
Leah Childers, Pittsburg State University

2:15 p.m. - 2:25 p.m.

**Span, Basis, and Eigenvectors: Using Dynamically Connected Representations to Reify Abstract Concepts in Algebra**  
Douglas A. Lapp, Central Michigan University

2:30 p.m. - 2:40 p.m.

**Strengthening the Teaching and Learning of "Function": Addressing the Classroom Challenges and Identifying Research Opportunities for Faculty**  
Donna Beers, Simmons College

2:45 p.m. - 2:55 p.m.

**Teaching an Introduction to Mathematical Research Course for First-Year Students**  
Debra Czarneski, Simpson College

3:00 p.m. - 3:10 p.m.

**The Induction-Recursion Parallel: An Example for Students**  
Keith Brandt, Rockhurst University

3:15 p.m. - 3:25 p.m.

**Topics for Actuarial Exam P/1**  
Daniel Biles, Belmont University

3:30 p.m. - 3:40 p.m.

**Using the JPEG Compression Algorithm in a First Linear Algebra Course**  
David Austin, Grand Valley State University

1:00 p.m. - 5:30 p.m., Thoroughbred 2 &amp; Thoroughbred 5

**Student Activity**

**Great Talks for a General Audience: Coached Presentations by Graduate Students**

Organizers: Jim Freeman, Cornell College; and Rachel Schwell, Central Connecticut State University

Thoroughbred 2

1:00 p.m. - 1:10 p.m.,

**Joint Introductory/Information Session**

1:15 p.m. - 1:35 p.m.

**Bubbles and Boundary: An Invitation to Isoperimetric Research**  
Donald Sampson

1:40 p.m. - 2:00 p.m.

**Algebraic Coding and the Reed Solomon Code**  
Robert Edward Campbell

2:05 p.m. - 2:25 p.m.

**Approximation by Rational Functions on Compact Nowhere Dense Sets in the Plane**  
Chris Mattingly

2:30 p.m. - 2:50 p.m.

**Packing Complete Graphs with  $k$ -stars**  
Dan Roberts

Saturday, August 6, 2011 (continued)

2:55 p.m. - 3:15 p.m.

**The Necessary Geometric Condition for the Solvability of the Inhomogeneous Cauchy Riemann Equation**  
*Young Hwan You*

3:20 p.m. - 3:40 p.m.

**Unification and the Multiple Bubble Conjecture**  
*Rebecca Dorff*

3:45 p.m. - 4:05 p.m.

**Using Computers to Solve Jigsaw Puzzles**  
*Susan Crook*

4:20- 5:30 p.m., Room A

**Panel discussion/questions**

Thoroughbred 5

1:15 p.m. - 1:35 p.m.

**Markov Chains for Self-Assembly: How to Create Something out of (Almost) Nothing**  
*Dana Randall, Amanda Pascoe Streib*

1:40 p.m. - 2:00 p.m.

**An Introduction to the Mandelbrot Set and Recent Related Results**  
*Scott Kaschner*

2:05 p.m. - 2:25 p.m.

**Geometric Properties of Quasihyperbolic Distance**  
*Poranee Khongkha Julian*

2:30 p.m. - 2:50 p.m.

**Lifting Commuting Involutions**  
*Kathryn Brenneman*

2:55 p.m. - 3:15 p.m.

**Matrix Decompositions**  
*Laura Dykes*

3:20 p.m. - 3:40 p.m.

**Parametric Toeplitz Operators**  
*Mehdi Nikpour*

3:45 p.m. - 4:05 p.m.

**“The Complete Measurer”: A Window into 19th Century Geometry**  
*Kristina Leifeste*

1:30 p.m. - 5:30 p.m.

**Environmental Mathematics  
Bus Trip**

**The Environment & Hydrology of the Lexington Area**  
*Leader: Peter Idstein, Dept of Earth & Environ. Science, University of Kentucky*

2:40 p.m. - 4:00 p.m., Thoroughbred 4

**Panel Session**

**Moving Up the Career Ladder in Academia**

*Organizers: Maeve McCarthy, Murray State University; Jacqueline Jensen, Sam Houston State University; Rebecca Garcia, Sam Houston State University; Georgia Benkart, University of Wisconsin*

*Panelists: Dora Ahmadi, Morehead State University; Stephen Kennedy, Carleton College; and Maura Mast, University of Massachusetts, Boston*

3:00 p.m. - 4:00 p.m., Thoroughbred 1

**Math Circles for Students and Teachers  
Math Circles Demonstrations**

3:00 p.m. - 3:45 p.m., Elkhorn A

**General Contributed Paper Session #9B  
Interdisciplinary Topics**  
*Ryan Rahrig, Bowling Green State University*

3:00 p.m. - 3:10 p.m.

**Creating a Real Music with Mathematical Ideas**  
*Duk-Hyung Lee, Asbury University*

3:15 p.m. - 3:25 p.m.

**Things to Do with a Broken Stick**  
*Gabriel Prajitura, State University of New York Brockport*

3:30 p.m. - 3:40 p.m.

**A Graph Theory Approach to an RNA Problem**  
*Ryan Rahrig, Ohio Northern University*

3:30 p.m. - 5:30 p.m., Hyatt Hotel Jessamine/Franklin Suites

**Minicourse #3, Part 2**

**An In-Class Role-Playing Game for Quantitative Literacy: Social Security, 1935**

*Presenters: John Curran and Andrew M. Ross, Eastern Michigan University*

3:30 p.m. - 5:30 p.m., Hyatt Hotel Woodford/Scott Suites

**Minicourse #6, Part 2**

**The Mathematics of Folding and Unfolding**  
*Presenter: Joseph O'Rourke, Smith College*

5:00 p.m. - 6:00 p.m., Elkhorn C

**SIGMAA Teaching Advanced High School Mathematics (TAHSM)  
Business Meeting**

6:00 p.m. - 9:00 p.m., Thoroughbred Prefunction Space, Level 3

**Silver and Gold Banquet**

*MC: Wade Ellis, West Valley Community College  
After Dinner Speaker: Joseph Gallian*

# Social Events

## MAA-PME Student Reception

Wednesday, August 3, 4:30 p.m. – 5:30 p.m.

## Math Jeopardy

Wednesday, August 3, 5:30 p.m. – 6:15 p.m.

Robert Vallin, Slippery Rock University; Michael Berry, University of Tennessee

**Answer:** A fun undergraduate mathematics contest to lead off MathFest.

**Question:** What is Math Jeopardy?

Four teams of students will provide the questions to go with the mathematical answers in many categories. Come cheer for your favorite team. The session will be emceed by Michael Berry.

## Opening Reception

Wednesday, August 3, 6:00 p.m. – 7:30 p.m.

The association is pleased to hold a reception with cash bar for all MathFest participants immediately preceding the Opening Banquet. This event will serve as the Grand Opening of the MathFest Exhibit Hall located in the Lexington Convention Center in the Heritage East Ballroom, 1st Floor.

## Opening Banquet

Wednesday, August 3, 7:30 p.m. – 9:30 p.m.

**MC:** Paul Zorn, MAA President

After dinner: *MAA: The Musical!*  
Alissa Crans, Annalisa Crannell, Art Benjamin, Bud Brown (musical director), Dan Kalman, David Bressoud, Francis Su, Frank Farris, Jennifer Beineke, Jenny Quinn, Matthew DeLong, Norm Richert, Paul Zorn, Talithia Williams, and other members of the MAA Players.

Written and directed by Annalisa Crannell, with lyrics by cast members and by Larry Lesser.

## Graduate Student Reception

Thursday, August 4, 5:30 p.m. – 6:30 p.m.

Estela A. Gavosto, University of Kansas; James Freeman, Cornell College

Graduate students are invited for some refreshments and to meet several of the invited speakers.

## Backgammon Night

Thursday, August 4, 6:00 p.m. – 11:00 p.m.

Art Benjamin

**6:00 p.m. Backgammon Practice Session**, conducted by Art Benjamin.

Learn how to play backgammon, including how to use the doubling cube and strategies for tournaments. Play some practice games and have fun. Students welcome!

**7:00 p.m. Backgammon Mathematics Quiz**, hosted by Art Benjamin and Jennifer Quinn.

Win big prize money for being able to answer mathematical questions, based on the game of backgammon. Aside from knowing the rules of the game, no prior backgammon playing experience is assumed.

**8:00 p.m. Backgammon Tournament**

Up to \$1,000 in cash prizes offered. No entry fee! Limited to 64 players. Sponsored by the U.S. Backgammon Federation. Participants who preregister on the website [usbgf.org](http://usbgf.org) are eligible for additional prizes. Participants can register on-site between 6:00 and 7:45 p.m. Students are especially welcome to play.

## AWM-MAA Morning Coffee

Friday, August 5, 8:00 a.m. – 8:25 a.m.

The Association for Women in Mathematics and the Mathematical Association of America invite you to enjoy coffee and light refreshments before the Etta Z. Falconer Lecture.

## Pi Mu Epsilon Student Banquet and Awards Ceremony

Friday, August 5, 6:00 p.m. – 7:45 p.m.

## MAA Ice Cream Social and Undergraduate Awards Ceremony

Friday, August 5, 9:00 p.m. – 10:00 p.m.

We will recognize all students who gave talks in the MAA Student Paper Sessions and award prizes for the best of them. All undergraduate students are invited to attend.

## Silver & Gold Banquet

Saturday, August 6, 6:00 p.m. – 9:00 p.m.

**MC:** Wade Ellis, West Valley Community College

**Speaker:** Joseph Gallian, University of Minnesota Duluth

*“The Making of the 2003 and 2010 Math Awareness Month Posters”*

In this talk I discuss the how Mathematics Awareness Month has been observed over the years. Particular attention will be paid to how the selection of themes for Mathematics Awareness Month 2003 and 2010 were made and how the images were created.

# Pentominoku

SATURDAY'S "PROBLEM OF THE DAY"

## Rules:

Fill in the grid so that each pentomino shape contains 1–5 exactly once, and each row and column contains 1–5 exactly TWICE.

2			4			3			4
	4							5	
		3					2		
2			1			1			3
				4	3				
				3	2				
4			1			2			5
		4					3		
	2							5	
1			5			4			1

Thanks to Brainfreeze Puzzles ([brainfreezepuzzles.com](http://brainfreezepuzzles.com)) for providing this year's MathFest Sudoku.

This year's puzzle will appear in a new book, *Taking Sudoku Seriously*, by Laura Taalman and Jason Rosenhouse, to be published in 2011 by Oxford University Press.

# Thank You MathFest Sponsors

The Mathematical Association of America would like to thank our 2011 Sponsors for so generously contributing to the success of MathFest.



LOOK FAMILIAR?

Math Homework

A+

Final Exam

F

SOLUTION

Software that eliminates the ability to cheat the system.

Watch a demo  
[hawkeslearning.com/thesolution](http://hawkeslearning.com/thesolution)



HAWKES LEARNING SYSTEMS



**MAA**

MATHEMATICAL ASSOCIATION OF AMERICA



# MAA Math Fest

**2012**

August 2-4

**MADISON** WISCONSIN